



# SUBMERSIBLE PUMPS

STAINLESS STEEL SERIES



60Hz  
CATALOGUE

## Powering a Greener Tomorrow

At Duke Plasto Technique Pvt. Ltd. we use the latest technology to deliver consistently high quality products. With our innovative pumping solutions we are touching million hearts every day.

Founded by Shri Prabhudas Patel, Shri Shantibhai Patel, Shri Dineshbhai Patel & Shri Rameshbhai Patel in the year 1989, Duke Plasto Technique Pvt. Ltd. has been a pioneer in providing quality pumping solutions to valued patrons spread worldwide. Since the last two decades, we have earned an outstanding reputation for providing unique solutions to cater to the diverse needs of the industry. Our success is the result of our

understanding of our customers, our technical expertise, our continuous innovation and our ability to infuse creative ideas and newer ways in delivering superior products. Not surprisingly, our customers have complete trust in us and have rated us the highest in customer satisfaction. Recognizing our commitment for quality, the Government of India has awarded us the National Quality Award in 2007.

Today, brand Duke has carved a niche for itself as a reliable water solutions provider. We are proud to gain the trust of our valued patrons.

## Tradition of Excellence for Quality Products

Duke Plasto Technique Pvt. Ltd. offers a wide range of high quality products, combined with exceptional services to customers searching for consistent quality and dependable services. Duke offers an extensive range of high quality uPVC

Casing Pipes, Column Pipes, Pressure Pipes, Elastomeric Sealing Ring Pipes, SWR Pipes and all types of PVC fittings and Energy Efficient Submersible Pumps & Motors, Monoblock Pumps, Centrifugal and Pressure Booster Pumps.

## Manufacturing setup with the Best Infrastructure

Harnessing the power of knowledge, expertise and an excellent infrastructure setup has kept us at the pinnacle of success. We, at Duke Plasto Technique Pvt. Ltd proudly boast of a manufacturing capability comparable to any world class facility around the globe. Latest, state-of-the-art, fully automated machinery has been procured from the no. 1 manufacturer of the world. We have successfully implemented state-of-the-art systems from Japan like KANBAN, KAIZEN, SQC, SPC & 5S, etc. The whole operation including the control panel and CNC machines are monitored through a

fully computerized setup. The manufacturing set is also equipped with all the safety measures as laid down by the Factory Act. Our commitment to deliver nothing but the best doesn't stop just here, from time to time, we continuously upgrade our world-class facilities to keep ourselves at the forefront.

Besides this, to provide a comfortable workplace for our employees, we have a Conference Hall, Rest Rooms, Library & Canteen facilities at our factory.

### MODEL IDENTIFICATION CODE

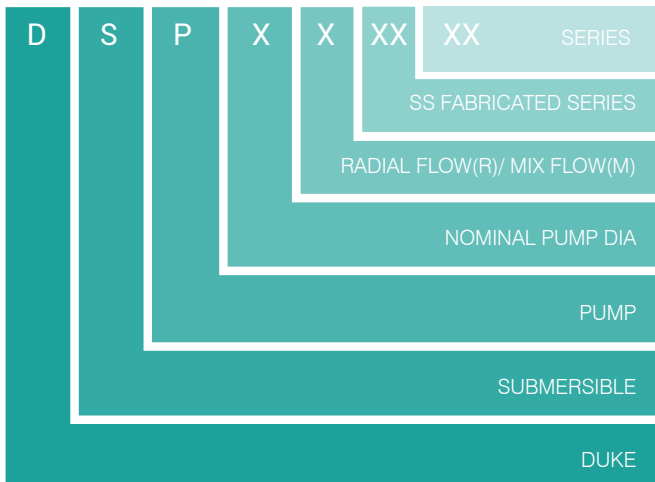

NOMINAL MOTOR DIA : 4",6",8",10",12"

SERIES: (02/03/05/08/14/09/17/30/46/60/77/95/125/160/215)



# CONTENTS

## Submersible Pumps

4" STAINLESS STEEL SUBMERSIBLE PUMP	6 - 20
6" MIXED FLOW STAINLESS STEEL SUBMERSIBLE PUMP	21 - 43
8" MIXED FLOW STAINLESS STEEL SUBMERSIBLE PUMP	44 - 48
10" MIXED FLOW STAINLESS STEEL SUBMERSIBLE PUMP	49 - 60

# APPLICATION



INDUSTRIAL



AGRICULTURE



FOUNTAIN



WATER SUPPLY



IRRIGATION  
SYSTEM

## Specifications & Advantages

1. Suction, Stage Casing and Discharge Outlets are made of SS AISI 304.
2. Impellers are made of SS AISI 304.
3. Pump shaft is made of SS 431.
4. Bearing Bush for shaft is made of anti friction Rubber to provide wear resistance against sand.
5. Non Return Valve is made of SS AISI 304.
6. Cable Guard and Strainer are made of SS AISI 304.
7. Pump and Motor couplings are according to NEMA Standard.
8. Coupling SS AISI 304.
9. Operating Range  
Head range : 1mtr to 485 mtr  
Flow rate : 17 lpm to 4600 lpm  
Immersion : 1 mtr minimum
10. Pumped liquids: Clean, thin, non-aggressive liquids without solid particles or fibres.



# SUBMERSIBLE PUMPS

## 1 Bearings with sand channels

All bearings are water-lubricated and have a squared shape enabling sand particles, if any, to leave the pump together with the pumped liquid.

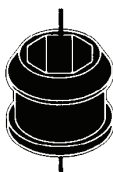

## 2 Inlet strainer

The inlet strainer prevents particles over a certain size from entering the pump.



## 3 Priming screw

All Duke 4" pumps are fitted with a priming screw. Consequently, dry running is prevented, because the priming screw will make sure that pump bearings are always lubricated.

Due to the semi-axial impellers of large pumps this priming is provided automatically.

However, it applies to all pump types that if the water table is lowered to a level below the pump inlet neither pump nor motor will be protected against dry running.

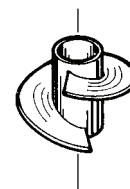

## 4 Non-return valve

All pumps are equipped with a reliable non-return valve in the valve casing preventing back flow in connection with pump stoppage.

Furthermore, the short closing time of the non-return valve means that the risk of destructive water hammer is reduced to a minimum.

The valve casing is designed for optimum hydraulic properties to minimize the pressure loss across the valve and thus to contribute to the high efficiency of the pump.

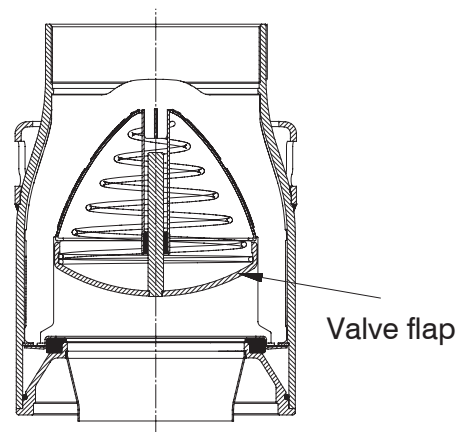

## 5 Stop ring

The stop ring prevents damage to the pump during transport and in case of up-thrust in connection with start-up.

The stop ring, which is designed as a thrust bearing, limits axial movements of the pump shaft.

The stationary part of the stop ring (A) is secured in the upper chamber.

The rotating part (B) is fitted above the split cone (C).

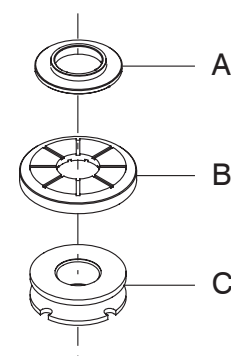

4"

## DSP4RFF02 SERIES PUMP DESIGN

### Material specification

No.	PART NAME	MATERIAL
1	N.R.V. 1.25"	SS AISI 304
2	VALVE	SS AISI 304
3	VALVE SEAT	N.B.R.
4	TOP BEARING HOUSING	SS AISI 304
5	TOP BEARING HOUSING BUSH	N.B.R.
6	TOP BEARING HOUSING SLEEVE	SS AISI 304
7	THRUST WASHER	SS AISI 304
8	TOP DIFFUSER	SS AISI 304
9	DIFFUSER	SS AISI 304
10	BEARING BUSH	N.B.R.
11	NECKRING	N.B.R. + P.P.S.
12	IMPELLER	SS AISI 304
13	STAGE SLEEVE	SS AISI 304
14	MIDDLE BEARING HOUSING	SS AISI 304
15	MIDDLE BEARING HOUSING BUSH	N.B.R. + S.S.304
16	MIDDLE BEARING HOUSING SLEEVE	SS AISI 304
17	PUMP SHAFT	SS AISI 431
18	FIRST STAGE DIFFUSER	SS AISI 304
19	STRAINER	SS AISI 304
20	NEMA COUPLING	SS AISI 304
21	SUCTION INTERCONNECTOR	SS AISI 304
22	CLAMPING STRIP	SS AISI 304
23	HEX NUT	A2-70 (316)
24	CABLE GUARD	SS AISI 304

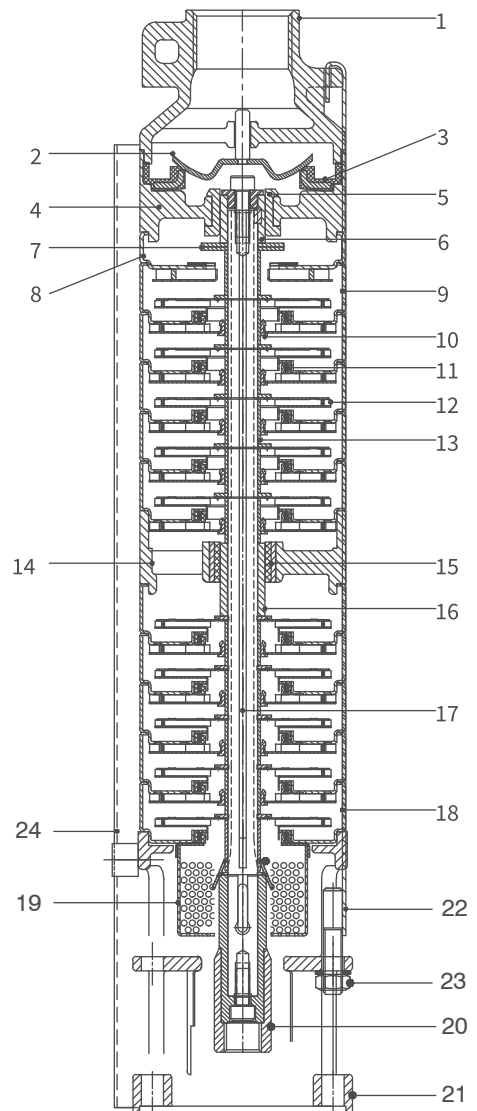

# Performance Curves

## DSP4RFF02, 60Hz

ISO 9906 Annexure A

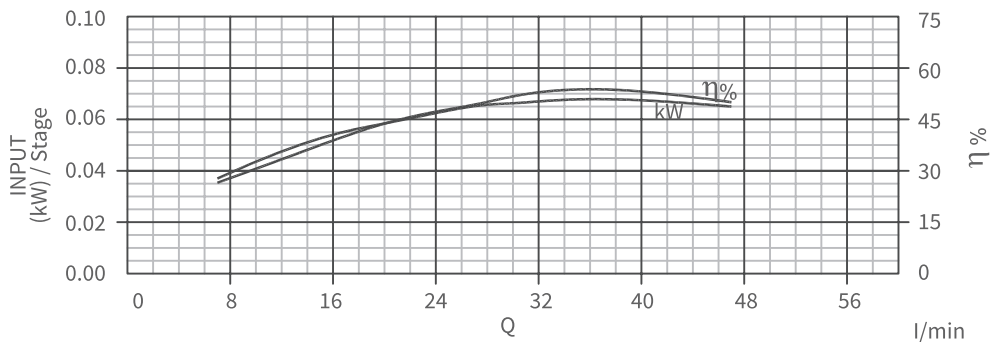
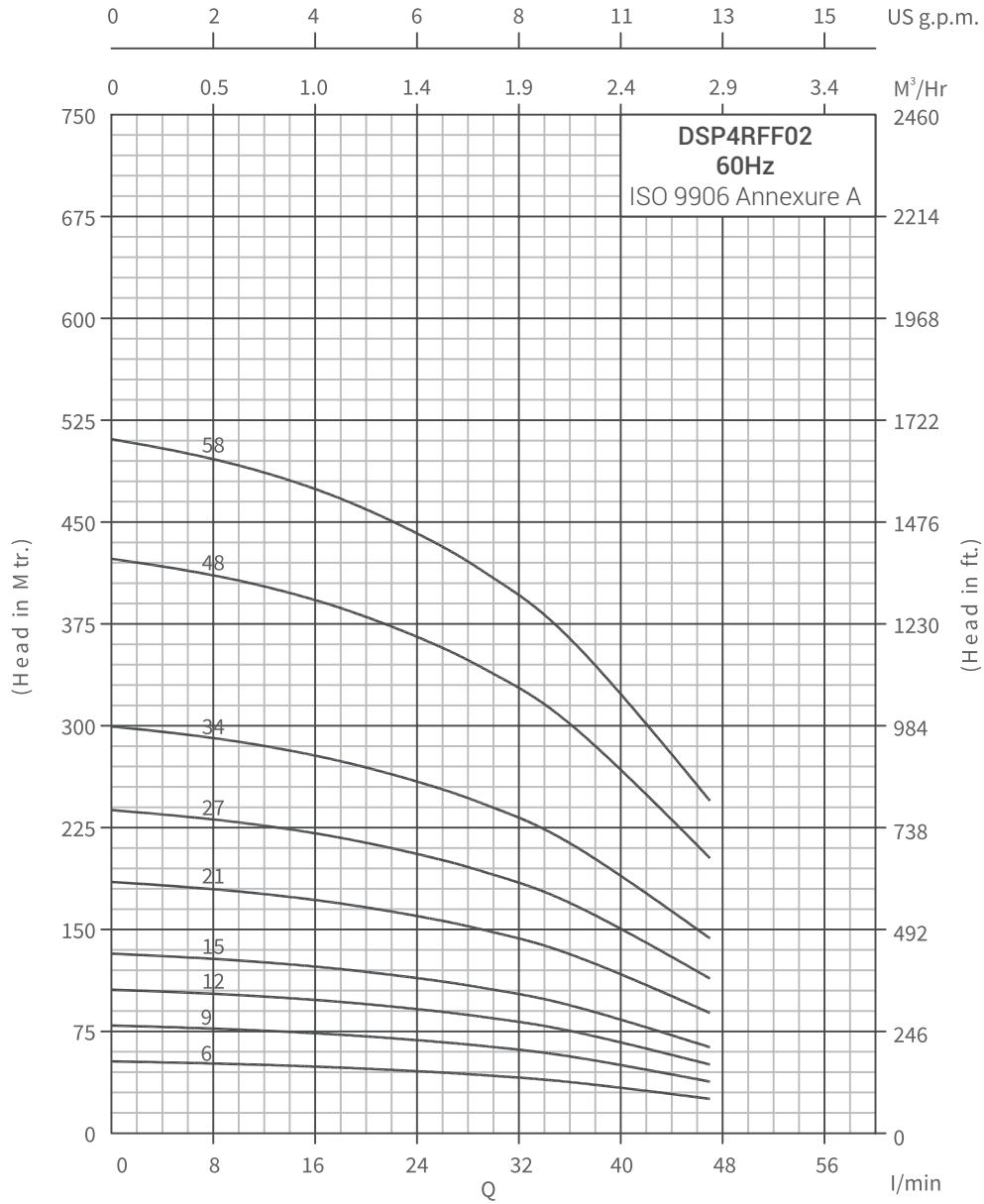

## DSP4RFF02, 60Hz

ISO 9906 Annexure A

kW	HP	Stage	Motor Joinings	Outlet Size	Discharge									
					m <sup>3</sup> /h	0	0.42	0.84	1.20	1.62	1.80	2.04	2.40	2.82
					l/min	0	7	14	20	27	30	34	40	47
0.37	0.5	6	V-4	1 1/2"	Head in Mtrs.	53	52	50	48	44	42	40	34	25
0.37	0.5	9	V-4	1 1/2"		79	78	75	71	66	63	60	50	38
0.55	0.75	12	V-4	1 1/2"		106	103	100	95	89	84	80	67	51
0.75	1	15	V-4	1 1/2"		132	129	125	119	111	106	100	84	63
1.1	1.5	21	V-4	1 1/2"		185	181	175	167	155	148	139	118	89
1.5	2	27	V-4	1 1/2"		238	233	224	214	199	190	179	151	114
2.2	3	34	V-4	1 1/2"		300	293	283	270	251	239	226	191	143
4	5.5	48	V-4	1 1/2"		423	414	399	381	354	338	319	269	203
4	5.5	58	V-4	1 1/2"		511	500	482	461	428	408	385	325	245

## Dimensions & Weights

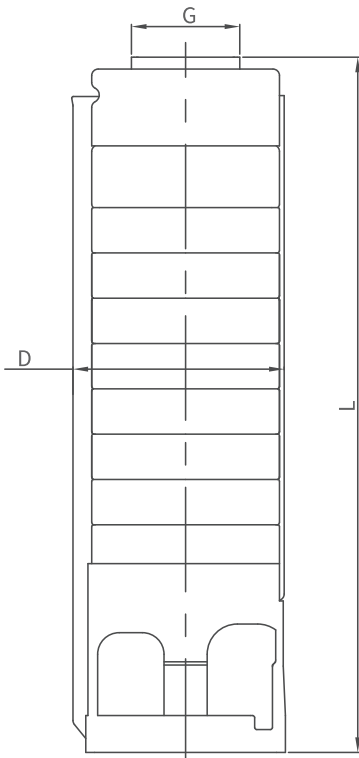

Model Name	Specification			
	D (mm)	L (mm)	Pump Weight Kg.	Weight (incl. pkg.) Kg.
DSP4RFF02 -06	98	280	3.2	3.5
DSP4RFF02 -09	98	343	4.2	4.7
DSP4RFF02 -12	98	406	5.2	5.8
DSP4RFF02 -15	98	469	6.2	7.0
DSP4RFF02 -21	98	626	8.3	9.4
DSP4RFF02 -27	98	752	10.0	11.4
DSP4RFF02 -34	98	971	12.4	13.9
DSP4RFF02 -48	98	1296	14.6	16.8
DSP4RFF02 -58	119	1714	27.4	29.7

G: Available Outlet Size 1.25" NPT

D: With Cable Guard

DP2 - 58 pump available in 4" Joining with mounted sleeve.



4"

## DSP4RFF03 SERIES PUMP DESIGN

### Material specification

No.	PART NAME	MATERIAL
1	N.R.V. 1.25"	SS AISI 304
2	VALVE	SS AISI 304
3	VALVE SEAT	N.B.R.
4	TOP BEARING HOUSING	SS AISI 304
5	TOP BEARING HOUSING BUSH	N.B.R.
6	TOP BEARING HOUSING SLEEVE	SS AISI 304
7	THRUST WASHER	SS AISI 304
8	TOP DIFFUSER	SS AISI 304
9	DIFFUSER	SS AISI 304
10	BEARING BUSH	N.B.R.
11	NECKRING	N.B.R. + P.P.S.
12	IMPELLER	SS AISI 304
13	STAGE SLEEVE	SS AISI 304
14	MIDDLE BEARING HOUSING	SS AISI 304
15	MIDDLE BEARING HOUSING BUSH	N.B.R. + S.S.304
16	MIDDLE BEARING HOUSING SLEEVE	SS AISI 304
17	PUMP SHAFT	SS AISI 431
18	FIRST STAGE DIFFUSER	SS AISI 304
19	STRAINER	SS AISI 304
20	NEMA COUPLING	SS AISI 304
21	SUCTION INTERCONNECTOR	SS AISI 304
22	CLAMPING STRIP	SS AISI 304
23	HEX NUT	A2-70 (316)
24	CABLE GUARD	SS AISI 304

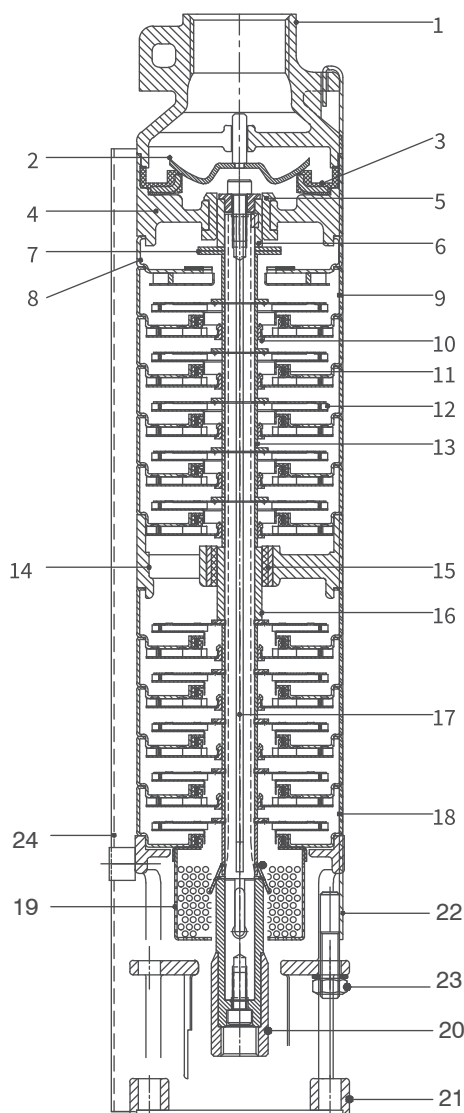

# DSP4RFF03, 60Hz

ISO 9906 Annexure A

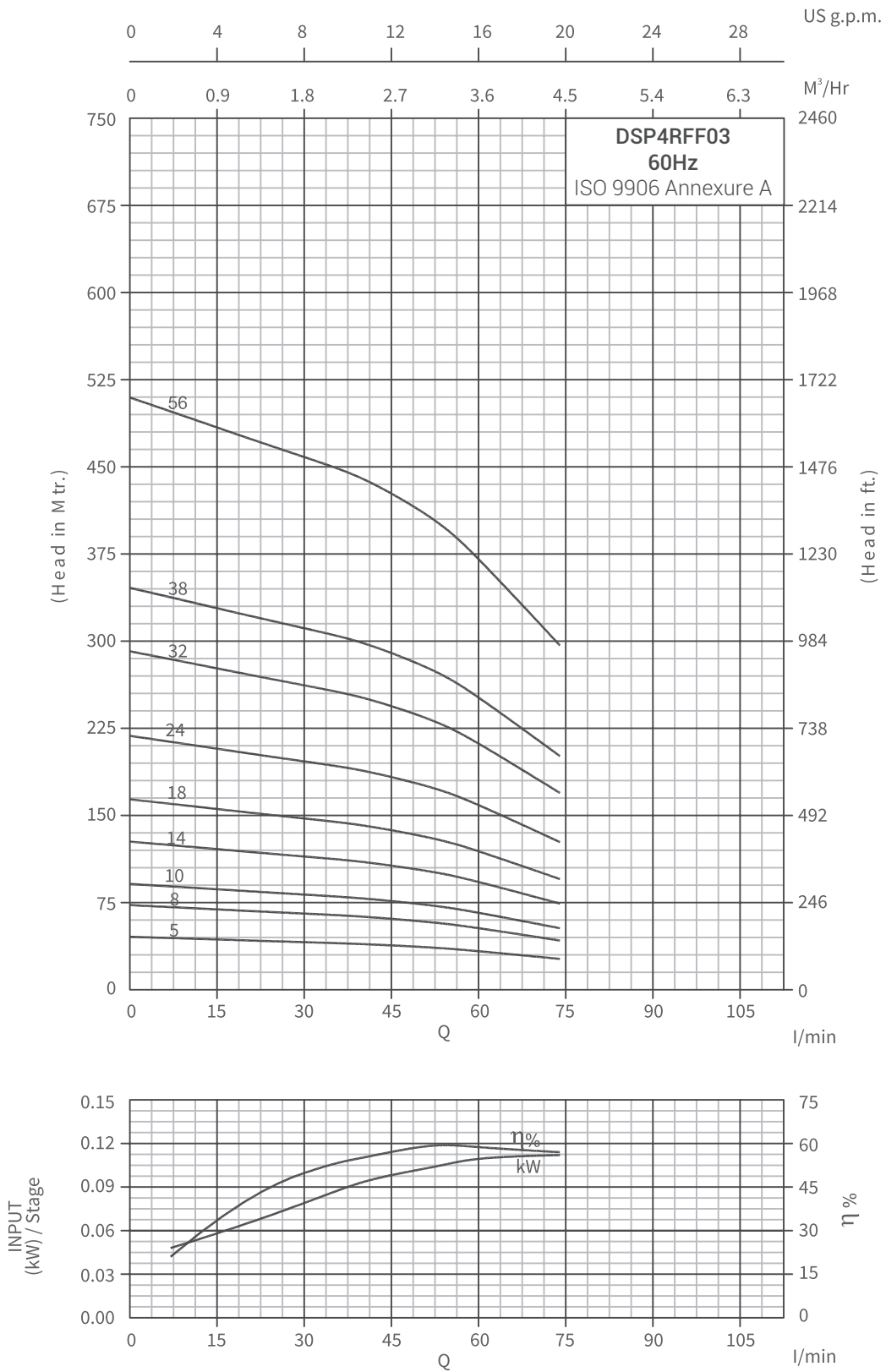

## DSP4RFF03, 60Hz

ISO 9906 Annexure A

kW	HP	Stage	Motor Joinings	Outlet Size	Discharge									
					m <sup>3</sup> /h	0	0.42	1.20	2.04	2.40	2.82	3.24	3.60	4.02
					l/min	0	7	20	34	40	47	54	60	67
0.37	0.5	5	V-4	1½"	Head in Mtrs.	46	44	42	40	39	38	36	33	26
0.55	0.75	8	V-4	1½"		73	68	68	65	63	60	57	53	42
0.75	1	10	V-4	1½"		91	85	85	81	79	75	71	66	53
1.1	1.5	14	V-4	1½"		127	124	119	113	110	105	100	93	74
1.5	2	18	V-4	1½"		164	160	153	145	142	136	129	120	95
2.2	3	24	V-4	1½"		218	213	204	194	189	181	171	159	127
3	4	32	V-4	1½"		291	284	271	258	252	241	228	212	169
4	5.5	38	V-4	1½"		346	338	322	307	299	286	271	252	201
5.5	7.5	56	V-4	1½"		510	498	475	452	441	422	400	372	296

## Dimensions & Weights

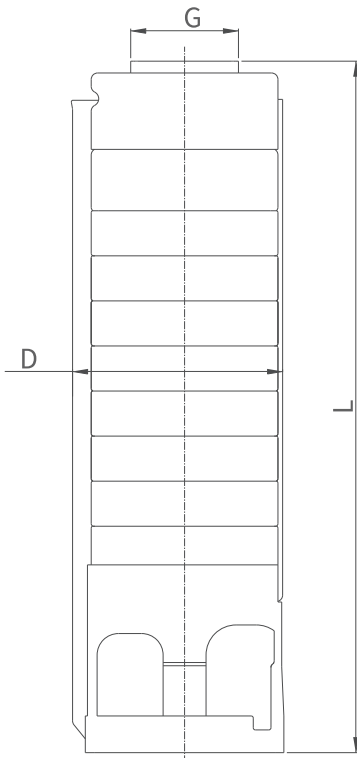

Model Name	Specification			
	D (mm)	L (mm)	Pump Weight Kg.	Weight (incl. pkg.) Kg.
DSP4RFF03 -05	98	259	3.2	3.5
DSP4RFF03 -08	98	322	4.2	4.6
DSP4RFF03 -10	98	364	4.8	5.3
DSP4RFF03 -14	98	448	6.2	6.9
DSP4RFF03 -18	98	532	7.4	8.3
DSP4RFF03 -24	98	689	9.5	10.7
DSP4RFF03 -32	98	857	11.9	13.5
DSP4RFF03 -38	98	1055	12.5	14.2
DSP4RFF03 -56	98	1675	26.0	28.5
DSP4RFF03 -56	144	1768	28.0	30.8

G: Available Outlet Size 1.25" NPT

D: With Cable Guard

DP3-56 pump available in 4" Joining with mounted sleeve

DP3-56 and

mounted sleeve DP3 -75 pump available in 6" Joining

# 4"

## DSP4RFF05 SERIES PUMP DESIGN

### Material specification

No.	PART NAME	MATERIAL
1	N.R.V. 1.25"	SS AISI 304
2	VALVE	SS AISI 304
3	VALVE SEAT	N.B.R.
4	TOP BEARING HOUSING	SS AISI 304
5	TOP BEARING HOUSING BUSH	N.B.R.
6	TOP BEARING HOUSING SLEEVE	SS AISI 304
7	THRUST WASHER	SS AISI 304
8	TOP DIFFUSER	SS AISI 304
9	DIFFUSER	SS AISI 304
10	BEARING BUSH	N.B.R.
11	NECKRING	N.B.R. + P.P.S.
12	IMPELLER	SS AISI 304
13	STAGE SLEEVE	SS AISI 304
14	MIDDLE BEARING HOUSING	SS AISI 304
15	MIDDLE BEARING HOUSING BUSH	N.B.R. + S.S.304
16	MIDDLE BEARING HOUSING SLEEVE	SS AISI 304
17	PUMP SHAFT	SS AISI 431
18	FIRST STAGE DIFFUSER	SS AISI 304
19	STRAINER	SS AISI 304
20	NEMA COUPLING	SS AISI 304
21	SUCTION INTERCONNECTOR	SS AISI 304
22	CLAMPING STRIP	SS AISI 304
23	HEX NUT	A2-70 (316)
24	CABLE GUARD	SS AISI 304

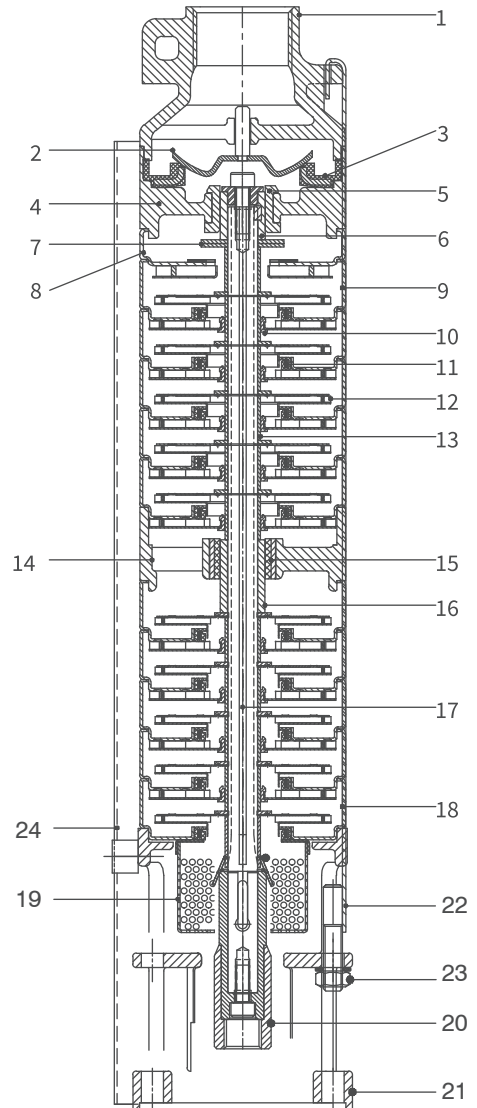

# DSP4RFF05, 60Hz

ISO 9906 Annexure A

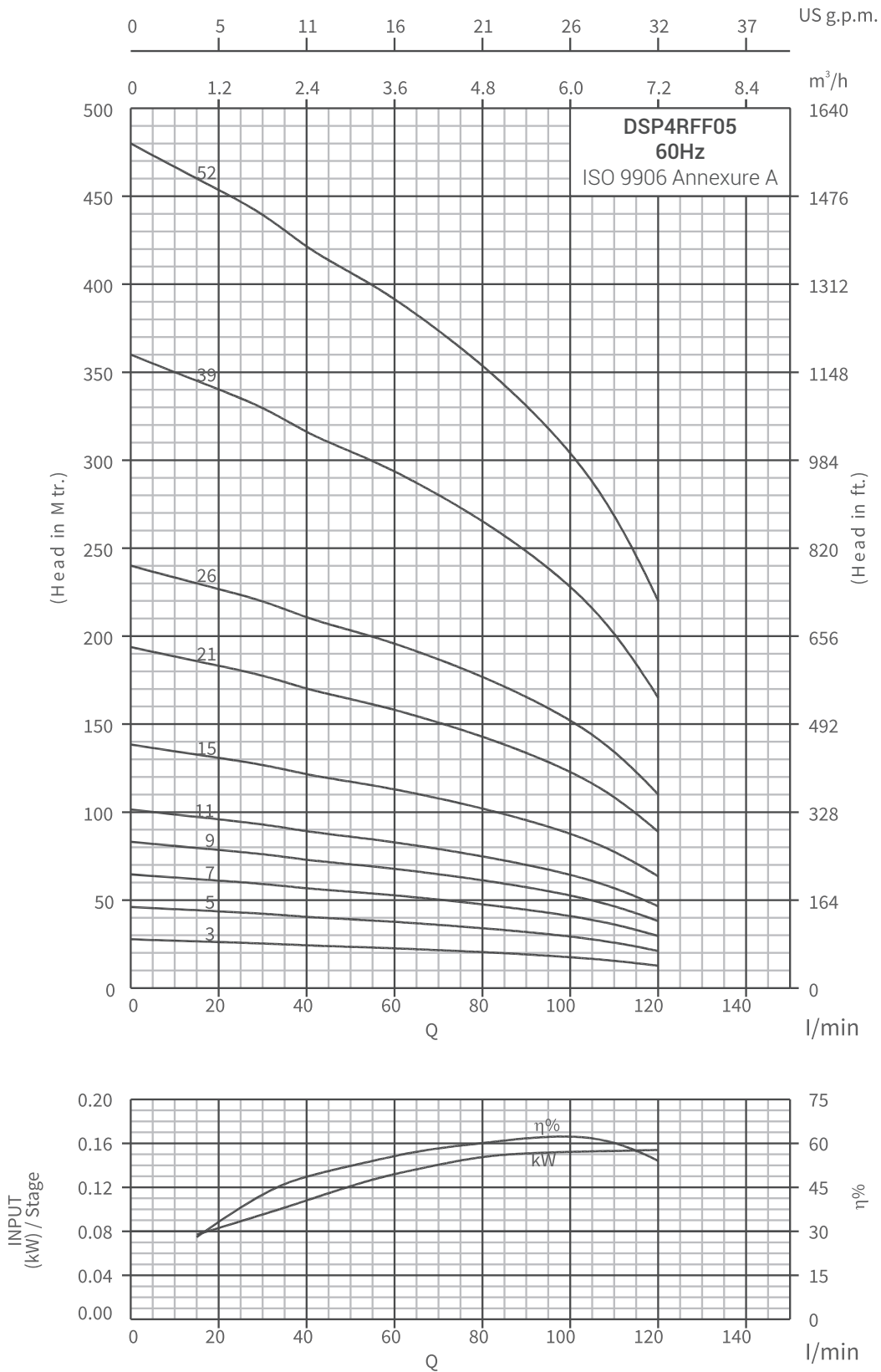

## DSP4RFF05, 60Hz

ISO 9906 Annexure A

kW	HP	Stage	Motor Joinings	Outlet Size	Discharge										
					m <sup>3</sup> /h	0	0.9	1.8	2.4	3.3	4.0	4.8	5.7	6.6	7.2
					l/min	0	15	30	40	55	67	80	95	110	120
0.37	0.5	3	V-4	1½"	Head in Mtrs.	28	27	26	24	23	22	20	18	16	13
0.55	0.75	5	V-4	1½"		46	44	42	40	38	36	34	31	26	21
0.75	1	7	V-4	1½"		65	62	60	56	54	51	48	43	37	30
1.1	1.5	9	V-4	1½"		83	80	76	73	69	66	61	55	48	38
1.5	2	11	V-4	1½"		102	97	94	89	85	80	75	68	58	47
2.2	3	15	V-4	1½"		138	133	128	121	116	110	102	92	79	63
3	4	21	V-4	1½"		194	186	178	169	162	153	143	129	111	89
4	5.5	26	V-4	1½"		240	230	221	210	200	190	177	160	137	110
5.5	7.5	39	V-4	1½"		360	345	332	315	300	285	266	240	206	165
7.5	10	52	V-4	1½"		480	460	442	420	400	380	355	320	275	220

## Dimensions & Weights

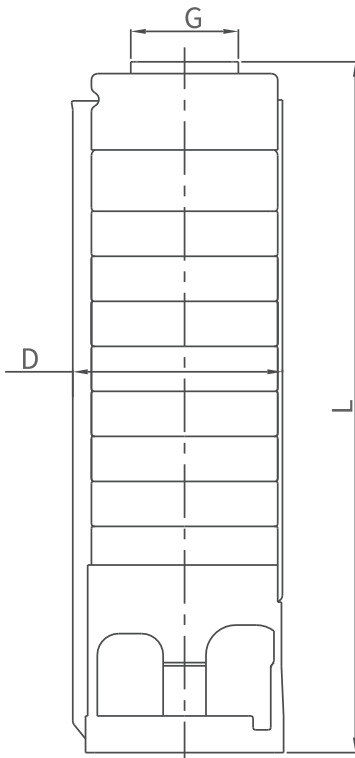

Model Name	Specification			
	D (mm)	L (mm)	Pump Weight Kg.	Weight (incl. pkg.) Kg.
DSP4RFF05 -03	98	217	3.1	3.3
DSP4RFF05 -05	98	259	3.4	3.7
DSP4RFF05 -07	98	301	3.8	4.2
DSP4RFF05 -09	98	343	4.2	4.7
DSP4RFF05 -11	98	385	5.2	5.8
DSP4RFF05 -15	98	469	6.6	7.4
DSP4RFF05 -21	98	626	8.4	9.5
DSP4RFF05 -26	98	731	10.0	11.3
DSP4RFF05 -39	98	1121	13.3	15.1
DSP4RFF05 -39	144	1285	20.0	21.8
DSP4RFF05 -52	144	1840	32.6	34.7

G: Available Outlet Size 1.5" NPT

D: With Cable Guard

DP4 -39 pump also available in 6" Joining

DP4 -52 pump available in 6" Joining mounted sleeve.

4"

## DSP4RFF08 SERIES PUMP DESIGN

### Material specification

No.	PART NAME	MATERIAL
1	N.R.V. 2.0"	SS AISI 304
2	VALVE	SS AISI 304
3	TOP BEARING BUSH	N.B.R.
4	TOP DIFFUSER	SS AISI 304
5	COLLET & COLLET NUT	SS AISI 304
6	IMPELLER	SS AISI 304
7	NECKRING	N.B.R. + NYLON
8	DIFFUSER	SS AISI 304
9	BEARING BUSH	N.B.R.
9	STAGE SLEEVE	SS AISI 304
10	PUMP SHAFT	S.S. AISI 431
11	CLAMPING STRIP	SS AISI 304
12	STRAINER	SS AISI 304
13	NEMA COUPLING	SS AISI 304
14	CABLE GUARD	SS AISI 304
15	SUCTION	SS AISI 304

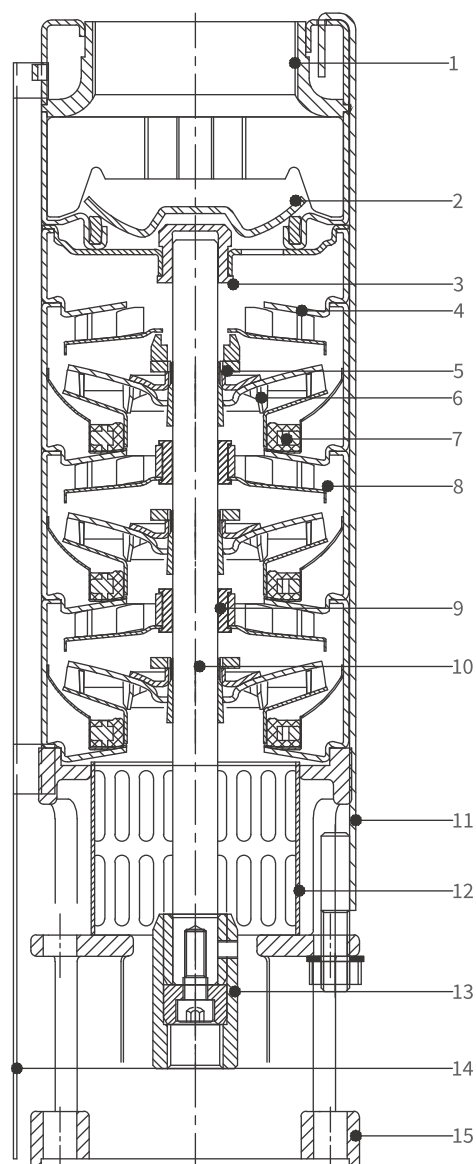

# DSP4RFF08, 60Hz

ISO 9906 Annexure A

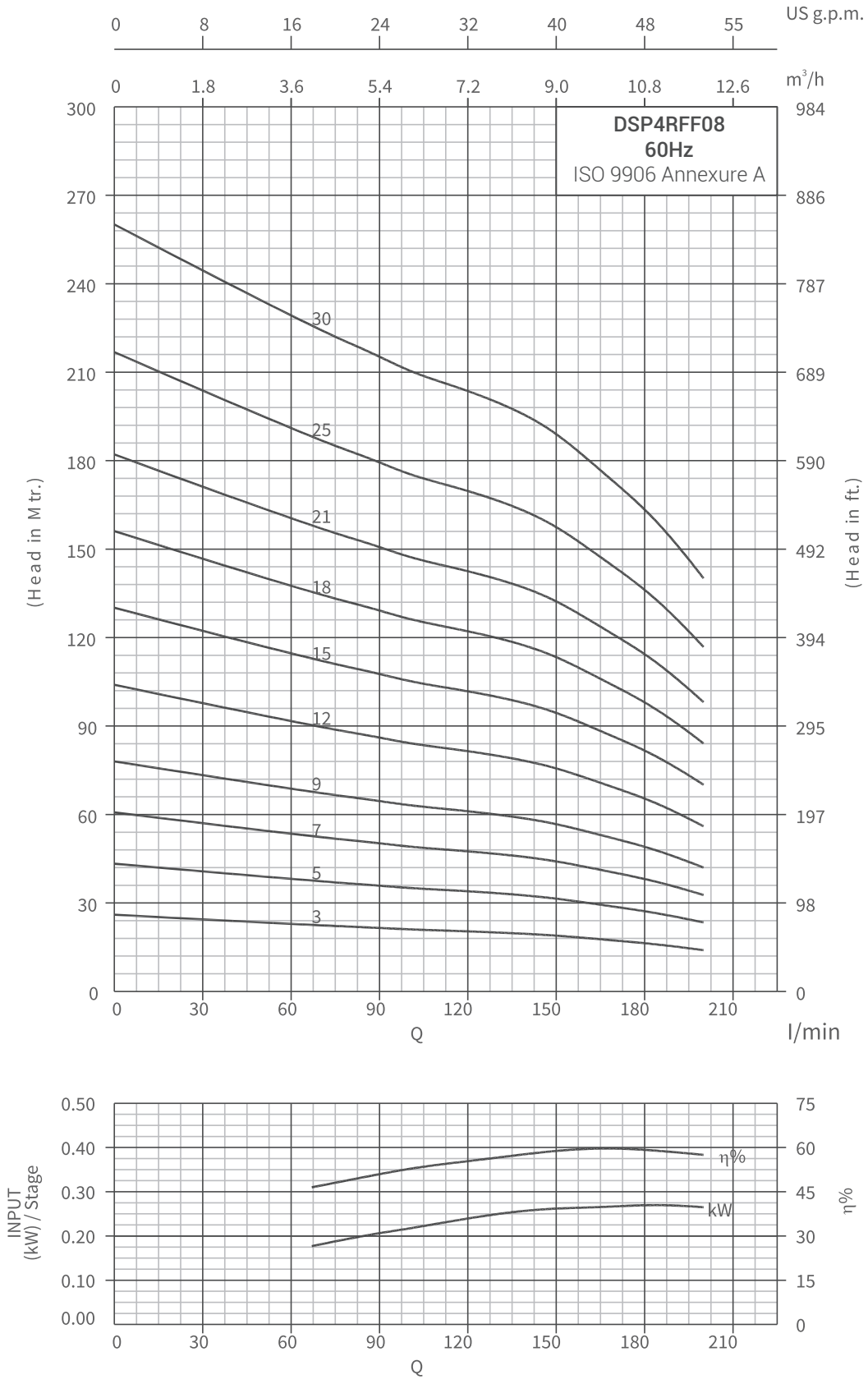



# Performance Chart

## DSP4RFF08, 60Hz

ISO 9906 Annexure A

kW	HP	Stage	Motor Joinings	Outlet Size	Discharge										
					m <sup>3</sup> /h	0	4.0	5.1	6.0	7.0	8.1	9.0	10.0	11.1	12.0
					l/min	0	67	85	100	117	135	150	167	185	200
0.55	0.75	3	V-4	2"	Head in Mtrs.	26	22.5	22	21	20.5	20	19	17	16	14
1.1	1.5	5	V-4	2"		43	38	36	35	34	33	32	29	27	23
1.5	2	7	V-4	2"		61	52	51	49	48	46	44	41	37	33
2.2	3	9	V-4	2"		78	68	65	63	61	59	57	52	48	42
3	4	12	V-4	2"		104	90	87	84	82	79	76	70	64	56
4	5.5	15	V-4	2"		130	112	109	105	102	99	95	87	80	70
5.5	7.5	18	V-4	2"		156	135	131	126	123	119	114	105	96	84
5.5	7.5	21	V-4	2"		182	158	153	147	143	139	133	122	112	98
5.5	7.5	25	V-4	2"		217	188	182	175	171	165	158	146	133	117
7.5	10	30	V-4	2"		260	225	218	210	205	198	190	175	160	140

## Dimensions & Weights

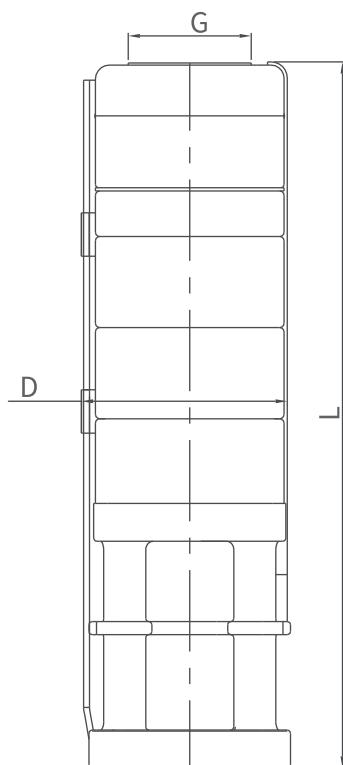

Model Name	Specification			
	D (mm)	L (mm)	Pump Weight Kg.	Weight (incl. pkg.) Kg.
DSP4RFF08 -03	98	326	6.7	9.7
DSP4RFF08 -05	98	410	7.2	10.2
DSP4RFF08 -07	98	494	7.7	10.7
DSP4RFF08 -09	98	578	8.2	11.2
DSP4RFF08 -12	98	704	8.9	11.9
DSP4RFF08 -15	98	830	9.7	12.7
DSP4RFF08 -18	98	956	10.5	13.5
DSP4RFF08 -21	98	1082	11.2	14.2
DSP4RFF08 -25	98	1250	12.3	15.3
DSP4RFF08 -30	98	1460	13.5	16.5

G: Available Outlet Size NPT 2.0"

D: With Cable Guard

DP8 -15, DP8 -18, DP8 -21, DP8 -25,  
DP8 -30, DP8 -37, DP8 -44, DP8 -50,  
pump are also available in 6" Joining.

# 4"

## DSP4RFF14 SERIES PUMP DESIGN

### Material specification

No.	PART NAME	MATERIAL
1	N.R.V. 2.0"	S.S AISI 304
2	VALVE	SS AISI 304
3	TOP BEARING BUSH	N.B.R.
4	TOP DIFFUSER	SS AISI 304
5	COLLET & COLLET NUT	SS AISI 304
6	IMPELLER	SS AISI 304
7	NECKRING	N.B.R. + NYLON
8	DIFFUSER	SS AISI 304
9	BEARING BUSH	N.B.R.
10	PUMP SHAFT	SS AISI 431
11	CLAMPING STRIP	SS AISI 304
12	STRAINER	SS AISI 304
13	NEMA COUPLING	SS AISI 304
14	CABLE GUARD	SS AISI 304
15	SUCTION	SS AISI 304

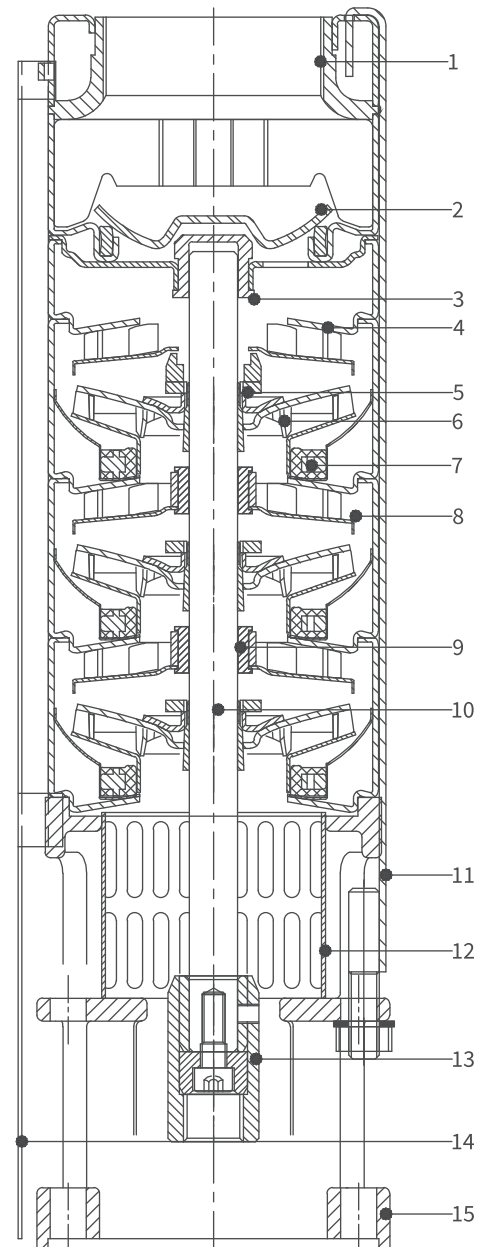

# DSP4RFF14, 60Hz

ISO 9906 Annexure A

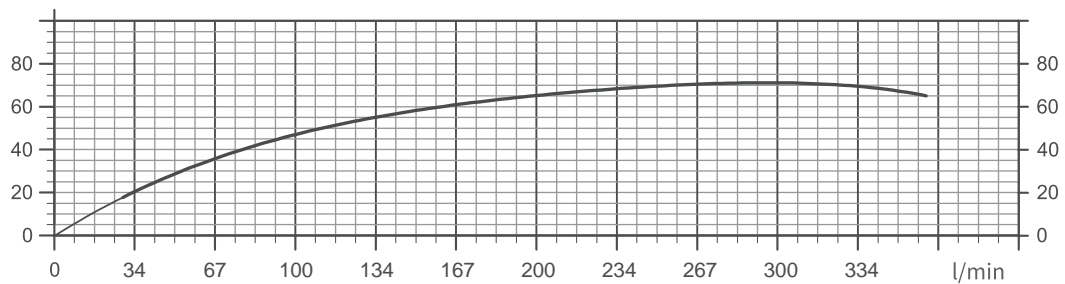
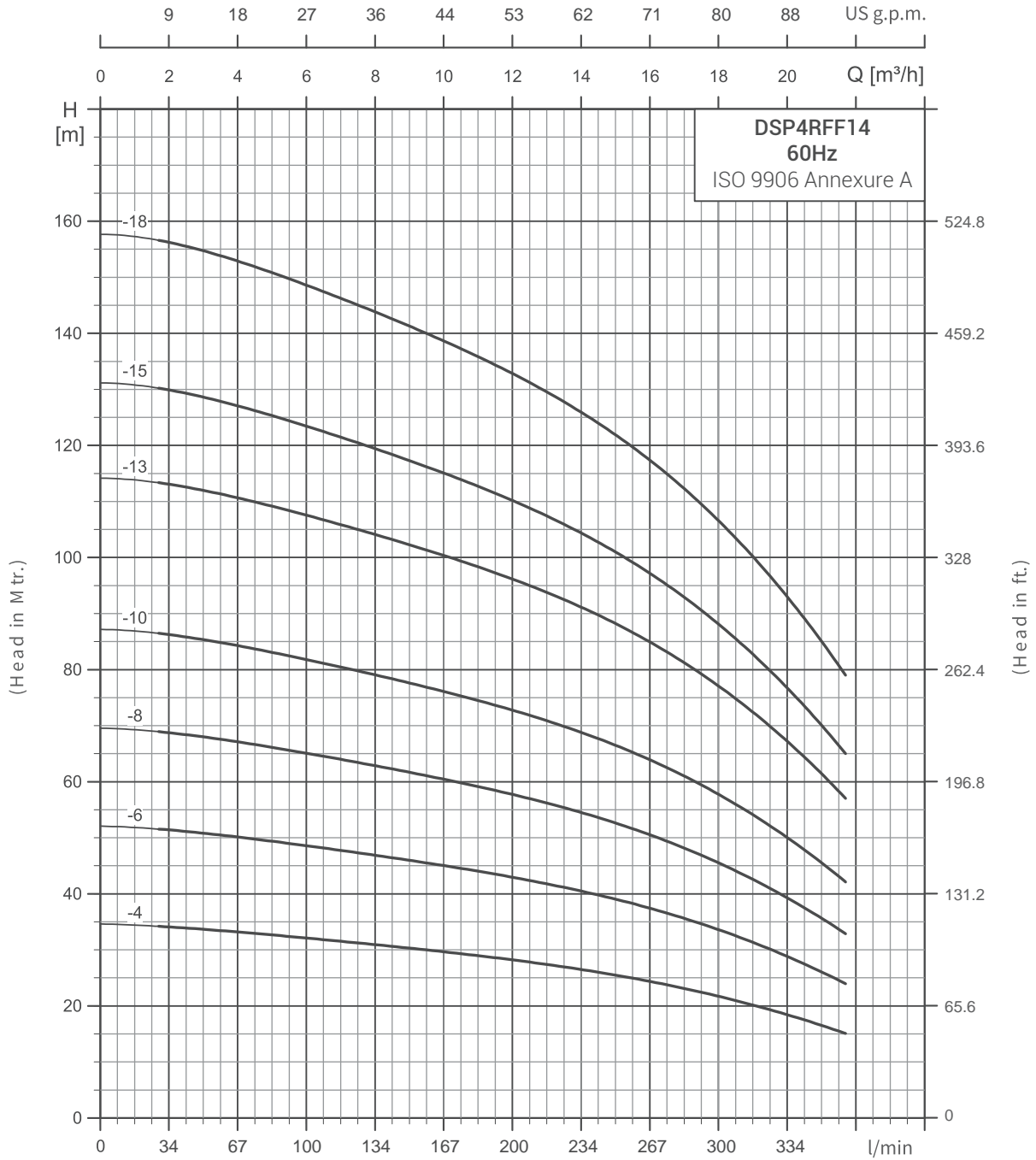

## DSP4RFF14, 60Hz

ISO 9906 Annexure A

kW	HP	Stage	Motor Joinings	Outlet Size	Discharge								
					m <sup>3</sup> /h	0	3	6	9	12	15	18	21.5
					l/min	0	50	100	150	200	250	300	358
1.5	2	4	V-4	2"	Head in Mtrs.	35	33	31	30	27	25	22	15
2.2	3	6	V-4	2"		52	51	48	46	43	38	34	25
3	4	8	V-4	2"		70	68	65	62	58	53	45	95
4.5	6	10	V-4	2"		87	85	82	77	73	66	58	43
5.5	7.5	13	V-4	2"		114	112	107	103	97	87	77	58
5.5	7.5	15	V-4	2"		132	127	123	117	110	102	87	65
7.5	10	18	V-4	2"		157	155	147	142	133	122	107	80

## Dimensions & Weights

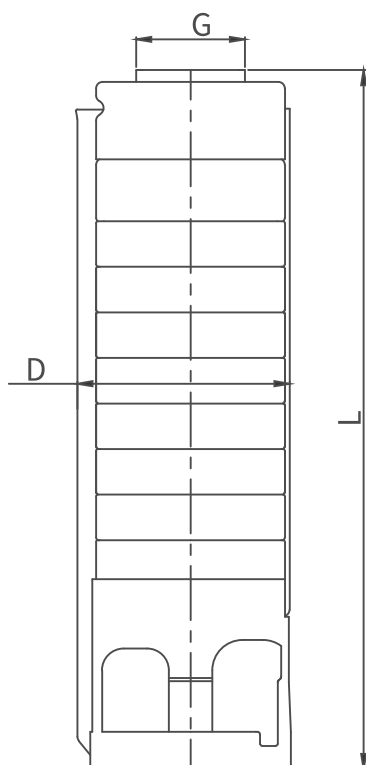

Model Name	Specification			
	D (mm)	L (mm)	Pump Weight Kg.	Weight (incl. pkg.) Kg.
DSP4RFF14 -4	101	538	18.6	21.6
DSP4RFF14 -6	101	688	21.5	24.5
DSP4RFF14 -4	101	538	21.1	24.1
DSP4RFF14 -6	101	688	24.7	27.7
DSP4RFF14 -8	101	838	28.3	31.3
DSP4RFF14 -10	101	988	33.9	36.9
DSP4RFF14 -13	101	1213	41.3	44.3
DSP4RFF14 -15	101	1363	42.9	45.9
DSP4RFF14 -18	101	1588	49.4	52.4
DSP4RFF14 -13	144	1276	51.7	54.7
DSP4RFF14 -15	144	1426	53.3	56.3
DSP4RFF14 -18	144	1651	58.7	61.7

6"

## DSP6MFF09 SERIES PUMP DESIGN

### Material specification

No.	PART NAME	MATERIAL
1	N.R.V.	S.S AISI 304
2	VALVE	SS AISI 304
3	VALVE SEAT	N.B.R. + S.S.304
4	TOP CAP	SS AISI 304
5	SPACING WASHER	PTFE
6	INTERMEDIATE CHAMBER TOP	SS AISI 304
7	BEARING BUSH	N.B.R.
8	NECKRING	N.B.R. + NYLON
9	INTERMEDIATE CHAMBER	SS AISI 304
10	COLLET & COLLET NUT	SS AISI 304
11	IMPELLER	SS AISI 304
12	PUMP SHAFT	S.S. AISI 431
13	CLAMPING STRIP	SS AISI 304
14	SUCTION CONNECTOR	SS AISI 304
15	STRAINER	SS AISI 304
16	NEMA COUPLING	SS AISI 304
17	CABLE GUARD	SS AISI 304
18	SUCTION	SS AISI 304
19	HEX NUT	A2-70 (316)

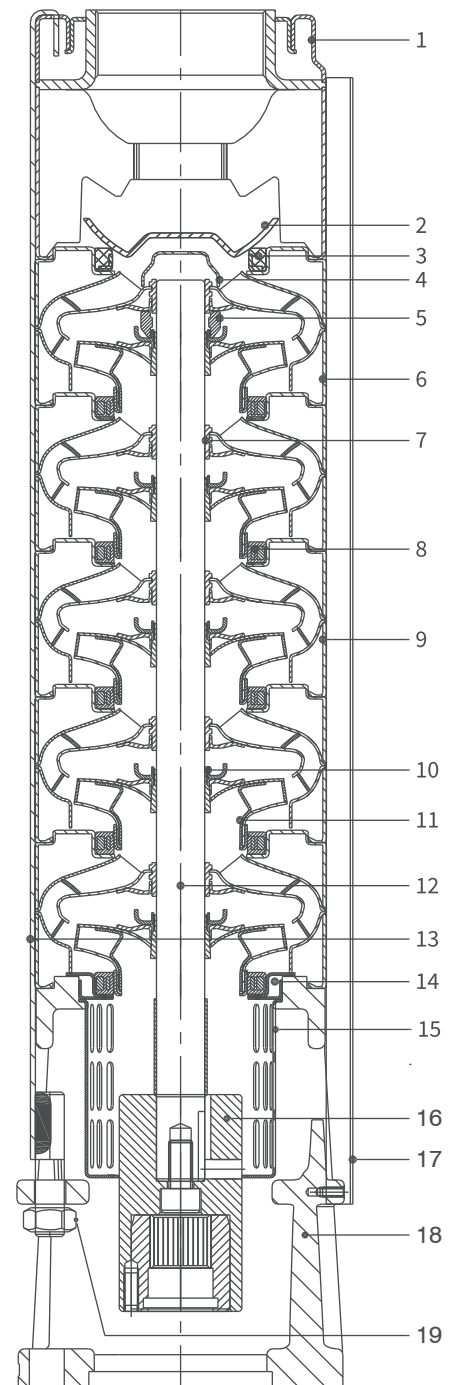

# DSP6MFF09, 60Hz

ISO 9906 Annexure A

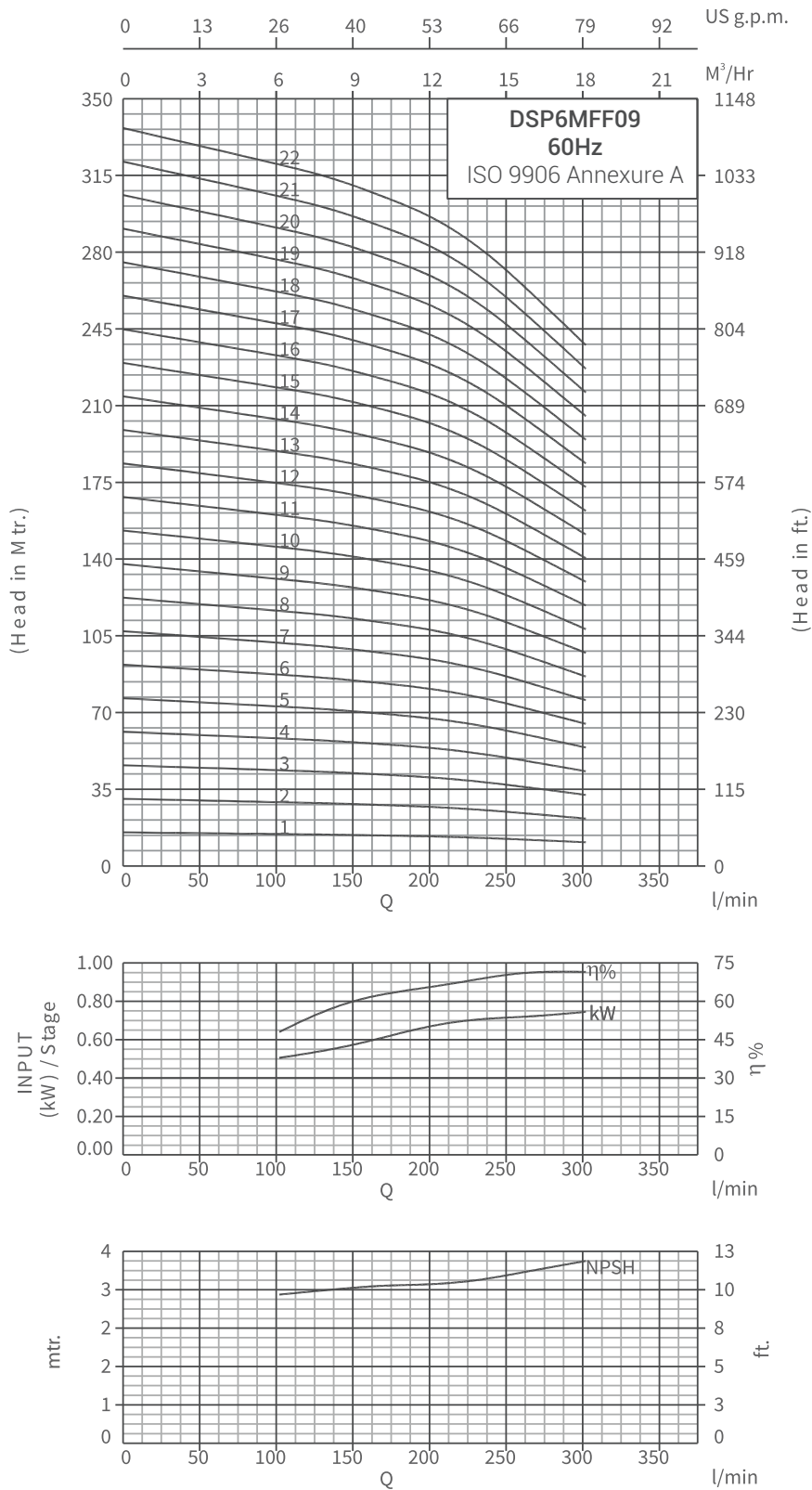

# DSP6MFF09, 60Hz

ISO 9906 Annexure A

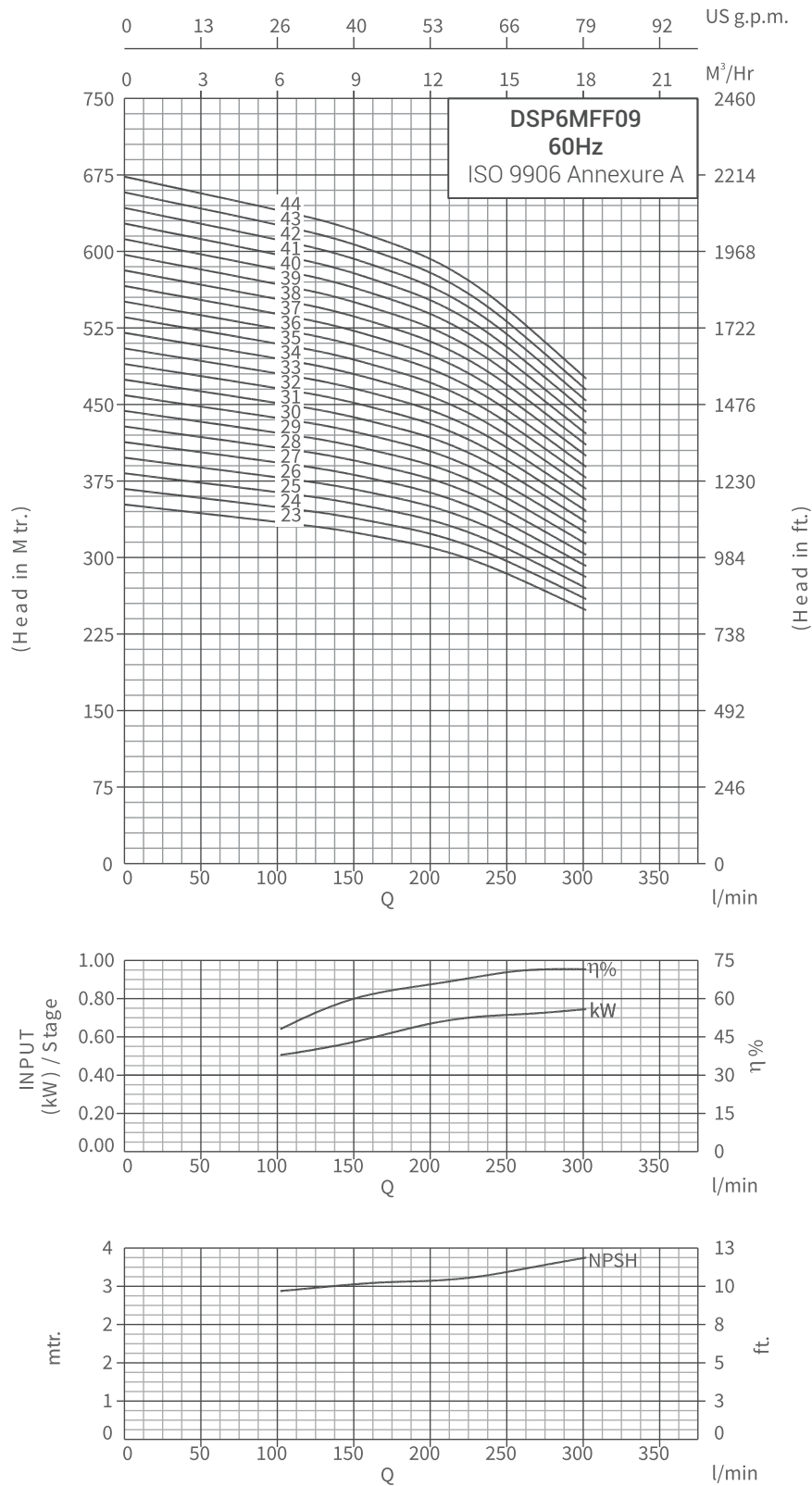

# DSP6MFF09, 60Hz

ISO 9906 Annexure A

kW	HP	Stage	Motor Joinings	Outlet Size	Discharge								
					m <sup>3</sup> /h	0	6.1	8.1	10.0	12.0	14.1	15.9	18.1
					l/min	0	102	135	168	201	235	266	302
0.75	1.00	1	V-6	2"BSP	Head in Mtrs.	15.3	14.5	14.3	14	13.5	13	12	11
1.50	2.00	2	V-6	2"BSP		31	29	29	28	27	26	24	22
2.20	3.00	3	V-6	2"BSP		46	44	43	42	40	38	36	32
3.00	4.00	4	V-6	2"BSP		61	58	57	56	54	51	48	43
4.00	5.50	5	V-6	2"BSP		76	73	72	70	68	64	60	54
5.50	7.50	6	V-6	2"BSP		92	87	86	83	81	77	71	65
5.50	7.50	7	V-6	2"BSP		107	102	103	97	94	90	83	76
7.50	10.00	8	V-6	2"BSP		122	116	114	111	108	102	95	86
7.50	10.00	9	V-6	2"BSP		135	131	129	125	122	115	107	97
7.50	10.00	10	V-6	2"BSP		153	146	143	139	135	128	119	108
9.30	12.50	11	V-6	2"BSP		168	160	157	153	148	141	131	119
9.30	12.50	12	V-6	2"BSP		184	175	172	167	162	154	143	130
9.30	12.50	13	V-6	2"BSP		199	189	186	181	176	166	155	140
11.00	15.00	14	V-6	2"BSP		214	204	200	195	189	179	167	151
11.00	15.00	15	V-6	2"BSP		230	218	214	208	202	192	178	162
13.00	17.50	16	V-6	2"BSP		245	233	229	222	216	205	190	173
13.00	17.50	17	V-6	2"BSP		260	247	243	236	230	218	202	184
13.00	17.50	18	V-6	2"BSP		275	262	257	250	243	230	214	194
15.00	20.00	19	V-6	2"BSP		291	276	272	264	256	243	226	205
15.00	20.00	20	V-6	2"BSP		306	291	286	278	270	256	238	216
15.00	20.00	21	V-6	2"BSP		321	306	300	292	284	269	250	227
18.50	25.00	22	V-6	2"BSP		337	320	315	3C6	297	282	262	238
18.50	25.00	23	V-6	2"BSP		352	335	329	320	310	294	274	248
18.50	25.00	24	V-6	2"BSP		367	349	343	334	324	307	286	259
18.50	25.00	25	V-6	2"BSP		382	364	358	34S	338	320	298	270
18.50	25.00	26	V-6	2"BSP		398	378	372	361	351	333	309	281
22.00	30.00	27	V-6	2"BSP		413	393	386	375	364	346	321	292
22.00	30.00	28	V-6	2"BSP		428	407	400	389	378	358	333	302
22.00	30.00	29	V-6	2"BSP		444	422	415	403	392	371	345	313
22.00	30.00	30	V-6	2"BSP		459	436	429	417	405	384	357	324
22.00	30.00	31	V-6	2"BSP		474	451	443	431	418	397	369	335
26.00	35.00	32	V-6	2"BSP		490	466	458	445	432	410	381	346
26.00	35.00	33	V-6	2"BSP		505	480	472	459	446	422	393	356
26.00	35.00	34	V-6	2"BSP		520	495	486	473	459	435	405	367
26.00	35.00	35	V-6	2"BSP		536	509	500	486	472	448	416	378
26.00	35.00	36	V-6	2"BSP		551	524	515	500	486	461	428	389
26.00	35.00	37	V-6	2"BSP		566	538	529	514	500	474	440	400
30.00	40.00	38	V-6	2"BSP		581	553	543	528	513	486	452	410
30.00	40.00	39	V-6	2"BSP		597	567	558	542	526	499	464	421
30.00	40.00	40	V-6	2"BSP		612	582	572	556	540	512	476	432
30.00	40.00	41	V-6	2"BSP		627	597	586	570	554	525	488	443
30.00	40.00	42	V-6	2"BSP		643	611	601	584	567	538	500	454
37.00	50.00	43	V-6	2"BSP		658	626	615	598	580	550	512	464
37.00	50.00	44	V-6	2"BSP		673	640	629	612	594	563	524	475



# DSP6MFF09, 60Hz

ISO 9906 Annexure A

## Dimensions & Weights

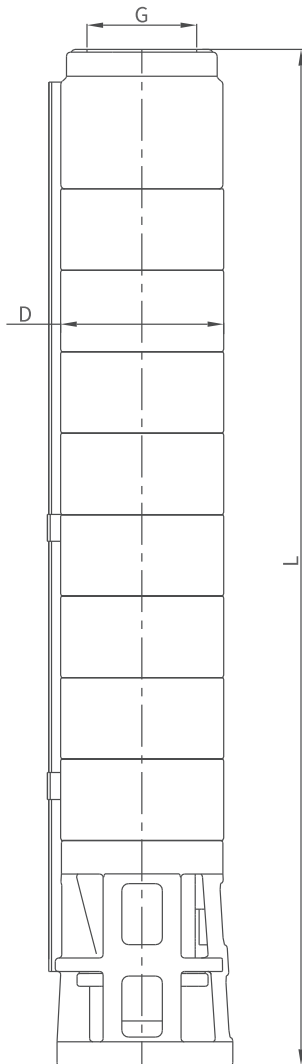

Model Name	Specification			
	D (mm)	L (mm)	Pump Weight Kg.	Weight (incl. pkg.) Kg.
DSP6MFF09 -01	144	331	8	10
DSP6MFF09 -02	144	392	9	11
DSP6MFF09 -03	144	452	10	12
DSP6MFF09 -04	144	513	12	14
DSP6MFF09 -05	144	573	13	15
DSP6MFF09 -06	144	634	14	16
DSP6MFF09 -07	144	694	15	17
DSP6MFF09 -08	144	755	17	19
DSP6MFF09 -09	144	815	18	20
DSP6MFF09 -10	144	876	19	21
DSP6MFF09 -11	144	936	20	23
DSP6MFF09 -12	144	997	22	24
DSP6MFF09 -13	144	1057	23	25
DSP6MFF09 -14	144	1118	24	26
DSP6MFF09 -15	144	1178	25	28
DSP6MFF09 -16	144	1239	26	29
DSP6MFF09 -17	144	1299	28	31
DSP6MFF09 -18	144	1360	29	32
DSP6MFF09 -19	144	1420	30	33
DSP6MFF09 -20	144	1481	31	34
DSP6MFF09 -21	144	1541	33	36
DSP6MFF09 -22	144	1602	34	37
DSP6MFF09 -23	144	1662	35	39
DSP6MFF09 -24	144	1723	36	40
DSP6MFF09 -25	144	1783	38	41
DSP6MFF09 -26	144	1844	39	42
DSP6MFF09 -27	144	1904	40	43
DSP6MFF09 -28	144	1965	41	45
DSP6MFF09 -29	144	2025	42	46
DSP6MFF09 -30	144	2086	44	47
DSP6MFF09 -31	144	2146	45	49
DSP6MFF09 -32	144	2207	46	50
DSP6MFF09 -33	144	2267	47	51
DSP6MFF09 -34	144	2328	49	53
DSP6MFF09 -35	144	2388	50	54
DSP6MFF09 -36	144	2449	51	55
DSP6MFF09 -37	144	2509	52	56
DSP6MFF09 -38	144	2570	53	57
DSP6MFF09 -39	144	2630	55	59
DSP6MFF09 -40	144	2691	56	60
DSP6MFF09 -41	144	2751	57	62
DSP6MFF09 -42	144	2812	58	63
DSP6MFF09 -43	144	2872	60	64
DSP6MFF09 -44	144	2933	61	65

G : Available Outlet Size NPT 2.5"

D: With Cable Guard

DP9-01 to DP9-10 pumps are also available in 4" joining

# 6"

## DSP6MFF17 SERIES PUMP DESIGN

### Material specification

No.	PART NAME	MATERIAL
1	N.R.V. 2.5"	S.S. AISI AISI 304
2	VALVE	S.S.304
3	VALVE SEAT	N.B.R. + S.S. AISI 304
4	TOP CAP	S.S. AISI 304
5	SPACING WASHER	25% CFT
6	INTERMEDIATE CHAMBER TOP	S.S. AISI 304
7	BEARING BUSH	N.B.R.
8	NECKRING	N.B.R. + NYLON
9	INTERMEDIATE CHAMBER	S.S. AISI 304
10	COLLET & COLLET NUT	S.S. AISI 304
11	IMPELLER	S.S. AISI 304
12	PUMP SHAFT	S.S. AISI 431
13	CLAMPING STRIP	S.S. AISI 304
14	SUCTION CONNECTOR	S.S. AISI 304
15	STRAINER	S.S. AISI 304
16	NEMA COUPLING	S.S. AISI 304
17	CABLE GUARD	S.S. AISI 304
18	SUCTION	S.S. AISI 304
19	HEX NUT	A2-70 (316)

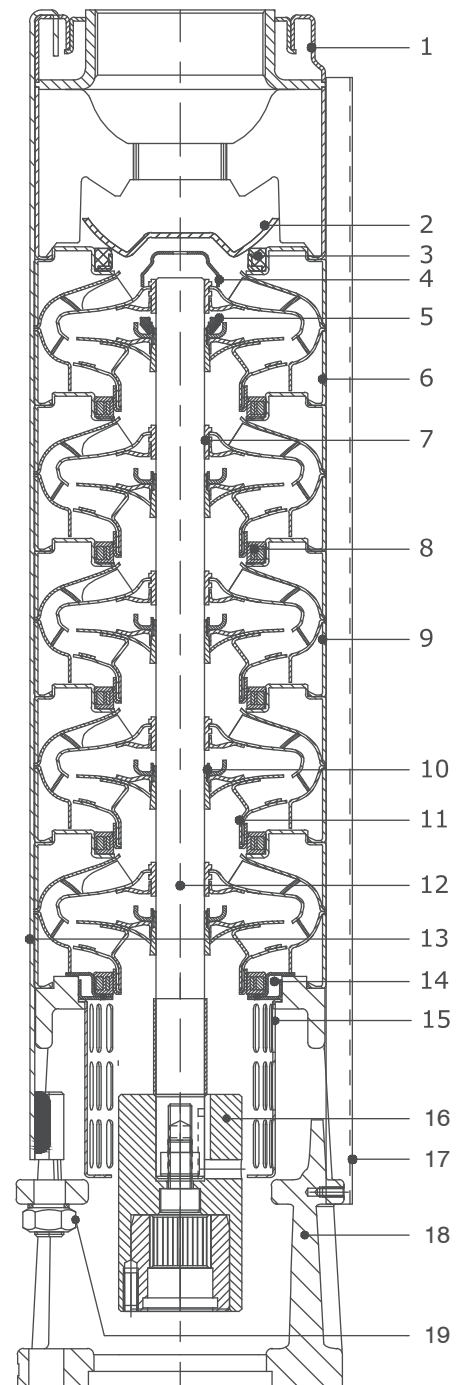

# DSP6MFF17, 60Hz

ISO 9906 Annexure A

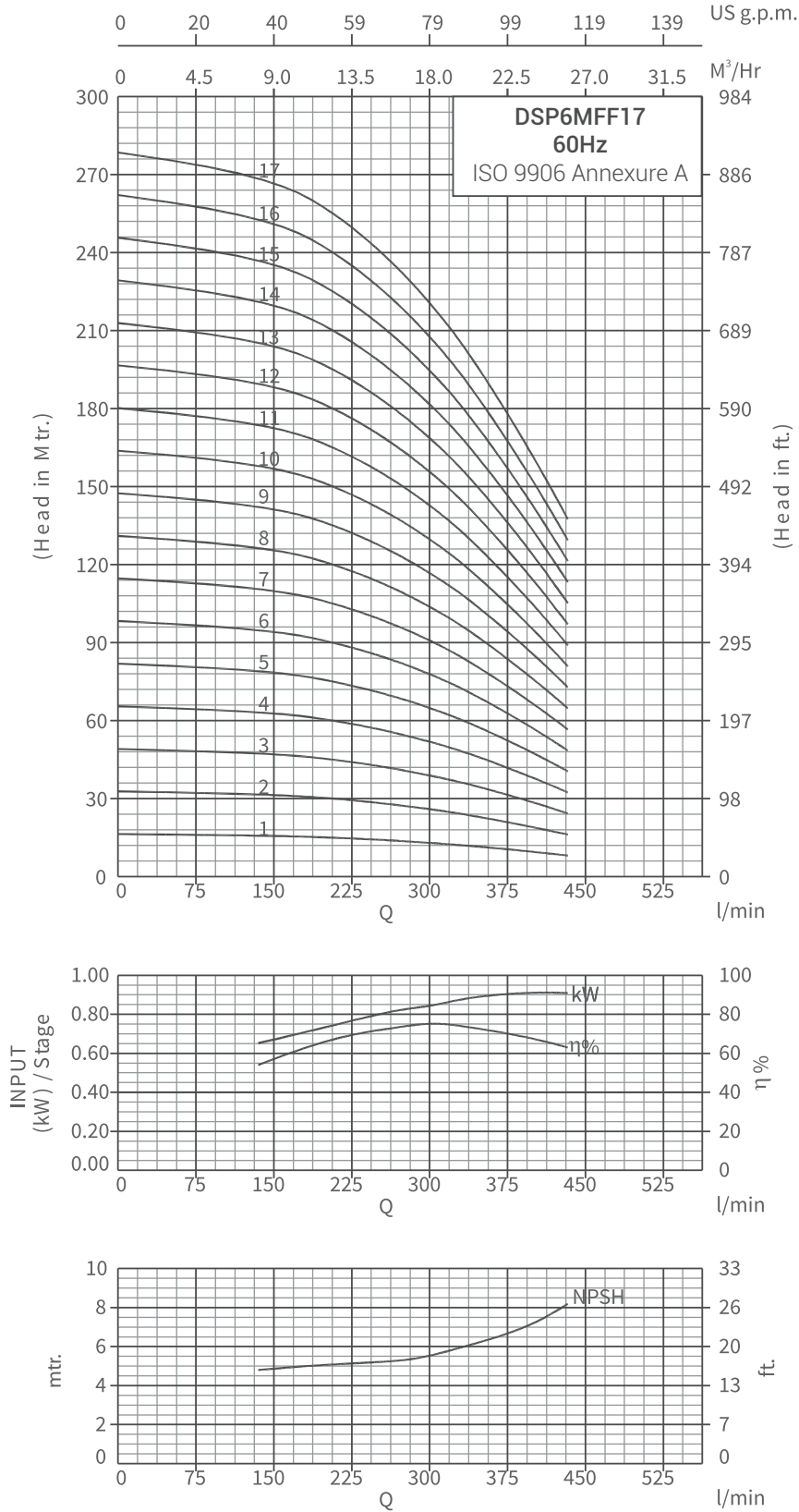

# DSP6MFF17, 60Hz

ISO 9906 Annexure A

kW	HP	Stage	Motor Joinings	Outlet Size	Discharge								
					m <sup>3</sup> /h	0	8.1	12	16	18	20	24	26
					l/min	0	135	200	267	300	333	400	433
1.1	1.5	1	V-6	2½" BSP	Head in Mtrs.	16.4	16	15	14	13	12	10	8
2.2	3	2	V-6	2½" BSP		33	32	30	28	26	24	19	16
3	4	3	V-6	2½" BSP		49	48	46	42	39	36	29	24
4	5.5	4	V-6	2½" BSP		66	64	61	55	52	48	38	32
5.5	7.5	5	V-6	2½" BSP		82	80	76	69	65	60	48	40
5.5	7.5	6	V-6	2½" BSP		98	96	91	83	78	72	57	49
7.5	10	7	V-6	2½" BSP		115	112	107	97	91	84	67	57
7.5	10	8	V-6	2½" BSP		131	128	122	111	104	96	76	65
7.5	10	9	V-6	2½" BSP		147	144	137	125	117	108	86	73
9.3	12.5	10	V-6	2½" BSP		164	160	152	139	130	120	96	81
9.3	12.5	11	V-6	2½" BSP		180	175	168	152	143	133	105	89
11	15	12	V-6	2½" BSP		197	191	183	166	156	145	115	97
11	15	13	V-6	2½" BSP		213	207	198	180	169	157	124	105
13	17.5	14	V-6	2½" BSP		229	223	213	194	182	169	134	113
13	17.5	15	V-6	2½" BSP		246	239	229	208	195	181	143	121
15	20	16	V-6	2½" BSP		262	255	244	222	208	193	153	129
15	20	17	V-6	2½" BSP		278	271	259	236	221	205	162	138

# DSP6MFF17, 60Hz

ISO 9906 Annexure A

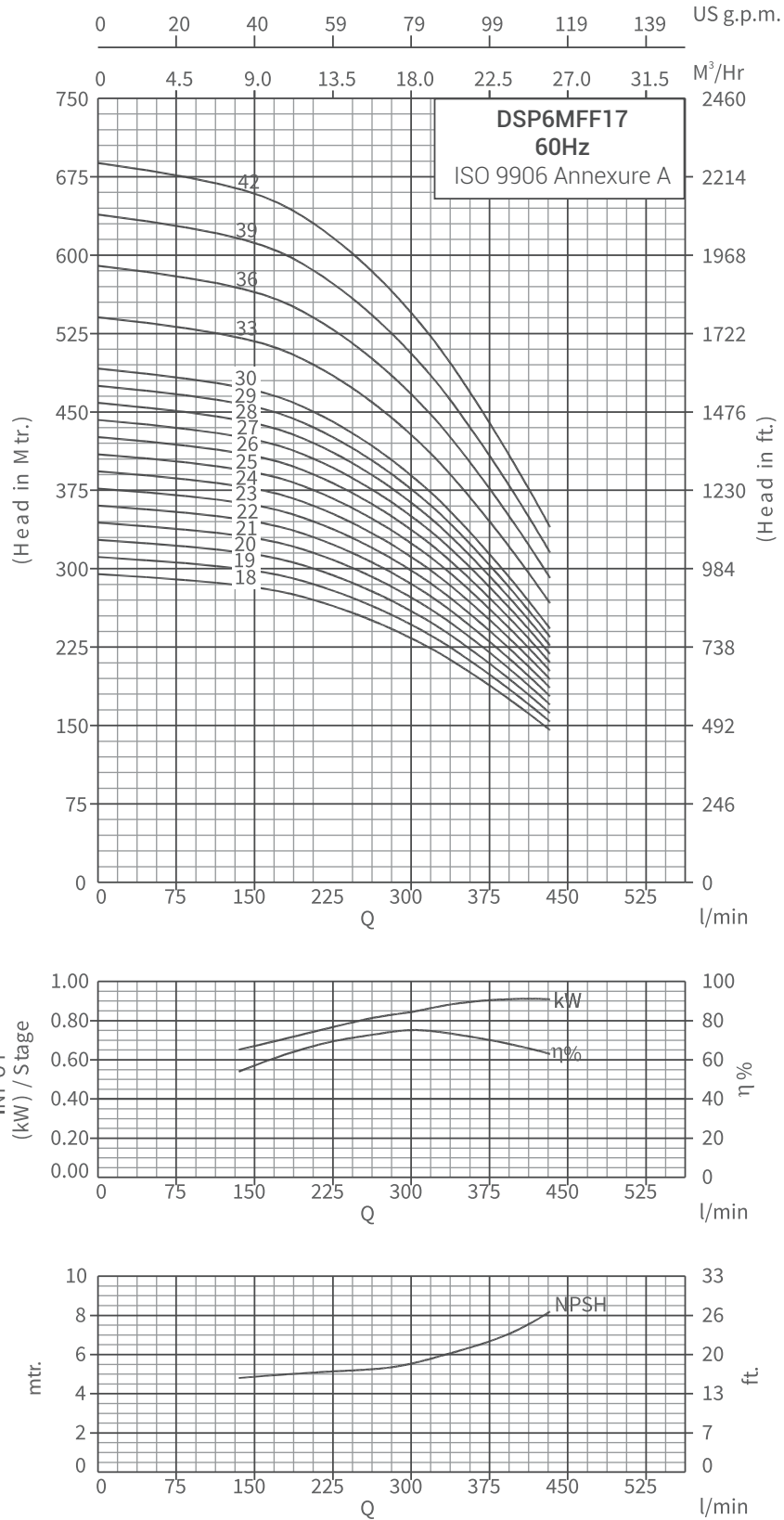

# DSP6MFF17, 60Hz

ISO 9906 Annexure A

kW	HP	Stage	Motor Joinings	Outlet Size		Discharge								
						m <sup>3</sup> /h	0	8.1	12	16	18	20	24	26
						l/min	0	135	200	267	300	333	400	433
15	20	18	V-6	2½" BSP	Head in Mtrs.	295	287	274	249	234	217	172	146	
18.5	25	19	V-6	2½" BSP		311	303	290	263	247	229	181	154	
18.5	25	20	V-6	2½" BSP		328	319	305	277	260	241	191	162	
18.5	25	21	V-6	2½" BSP		344	335	320	291	273	253	201	170	
18.5	25	22	V-6	2½" BSP		360	351	335	305	286	265	210	178	
22	30	23	V-6	2½" BSP		377	367	351	319	299	277	220	186	
22	30	24	V-6	2½" BSP		393	383	366	333	312	289	229	194	
22	30	25	V-6	2½" BSP		409	399	381	346	324	301	239	202	
22	30	26	V-6	2½" BSP		426	415	396	360	337	313	248	210	
26	35	27	V-6	2½" BSP		442	431	411	374	350	325	258	218	
26	35	28	V-6	2½" BSP		459	447	427	388	363	337	267	227	
26	35	29	V-6	2½" BSP		475	463	442	402	376	349	277	235	
26	35	30	V-6	2½" BSP		491	478	457	416	389	362	286	243	
30	40	33	V-6	2½" BSP		541	526	503	457	428	398	315	267	
30	40	36	V-6	2½" BSP		590	574	549	499	467	434	344	291	
37	50	39	V-6	2½" BSP		639	622	594	541	506	470	372	316	
37	50	42	V-6	2½" BSP		688	670	640	582	545	506	401	340	

# DSP6MFF17, 60Hz

ISO 9906 Annexure A

## Dimensions & Weights

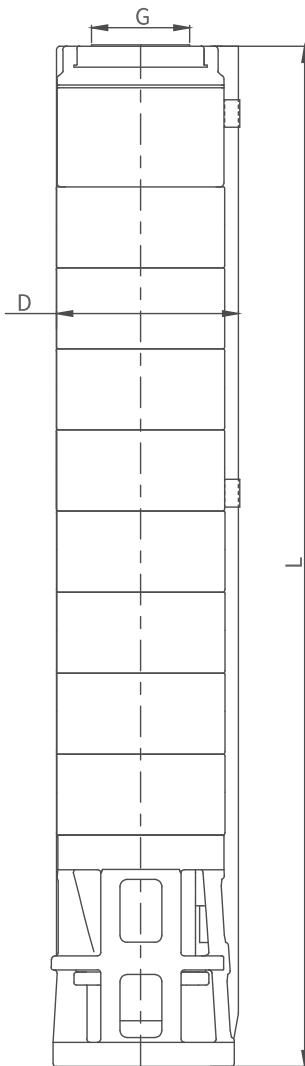

Model Name	Specification			
	D (mm)	L (mm)	Pump Weight Kg.	Weight (incl. pkg.) Kg.
DSP6MFF17 -01	144	331	8	10
DSP6MFF17 -02	144	392	9	11
DSP6MFF17 -03	144	452	11	13
DSP6MFF17 -04	144	513	12	14
DSP6MFF17 -05	144	573	13	15
DSP6MFF17 -06	144	634	14	16
DSP6MFF17 -07	144	694	16	18
DSP6MFF17 -08	144	755	17	19
DSP6MFF17 -09	144	815	18	20
DSP6MFF17 -10	144	876	19	21
DSP6MFF17 -11	144	936	21	23
DSP6MFF17 -12	144	997	22	24
DSP6MFF17 -13	144	1057	23	26
DSP6MFF17 -14	144	1118	24	27
DSP6MFF17 -15	144	1178	26	28
DSP6MFF17 -16	144	1239	27	30
DSP6MFF17 -17	144	1299	28	31
DSP6MFF17 -18	144	1360	29	32
DSP6MFF17 -19	144	1420	31	34
DSP6MFF17 -20	144	1481	32	35
DSP6MFF17 -21	144	1541	33	37
DSP6MFF17 -22	144	1602	34	38
DSP6MFF17 -23	144	1662	36	39
DSP6MFF17 -24	144	1723	37	40
DSP6MFF17 -25	144	1783	38	42
DSP6MFF17 -26	144	1844	39	43
DSP6MFF17 -27	144	1904	41	44
DSP6MFF17 -28	144	1965	42	45
DSP6MFF17 -29	144	2025	43	47
DSP6MFF17 -30	144	2086	44	48
DSP6MFF17 -33	144	2147	46	49
DSP6MFF17 -36	144	2208	48	51
DSP6MFF17 -39	144	2269	50	53
DSP6MFF17 -42	144	2330	52	55

G : Available Outlet Size NPT 2.5"

D: With Cable Guard

DP17-01 to DP17-09 pumps are also available in 4" joining

DP17 -33, DP17 -36, DP17 -39 & DP17 -42

pumps are available in 6" joining with mounted sleeve

& outlet size NPT 3.0"

# 6"

## DSP6MFF30 SERIES PUMP DESIGN

### Material specification

No.	PART NAME	MATERIAL
01	SUCTION 6X6	SS AISI 304
02	COUPLING	SS AISI 304
03	SHAFT	SS AISI 431
04	SUCTION CONNECTOR	SS AISI 304
05	INTERMEDIATE CHAMBER	SS AISI 304
06	IMPELLER	SS AISI 304
07	COLLET NUT	SS AISI 304
08	COLLET	SS AISI 304
09	STAGE RUBBER BUSH	NBR
10	NECK RING	NBR+ NYLON66
11	VALVE SHEET	SS+RUBBER
12	VALVE	SS AISI 304
13	CABLE GUARD	SS AISI 304
14	DISCHARG	SS AISI 304
15	BEARING BUSH TOP&BOTTOM	NBR+SS AISI 304
16	STOP RING	SS AISI 304
17	SPACING WASHER	CFT 25%
18	STARINER	SS AISI 304
19	CLAMPING STRIP	SS AISI 304
20	O RING	NITRIAL RUBBER

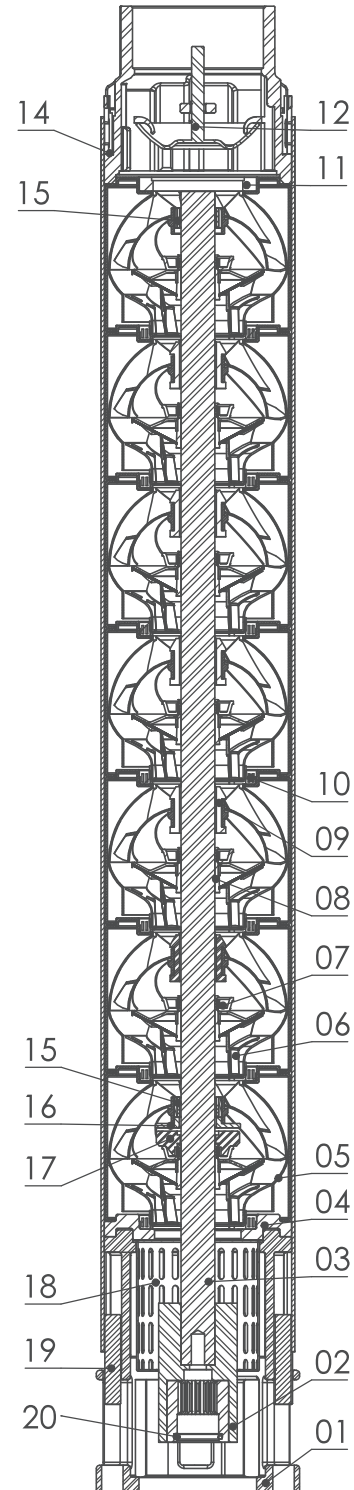



# DSP6MFF30, 60Hz

ISO 9906 Annexure A

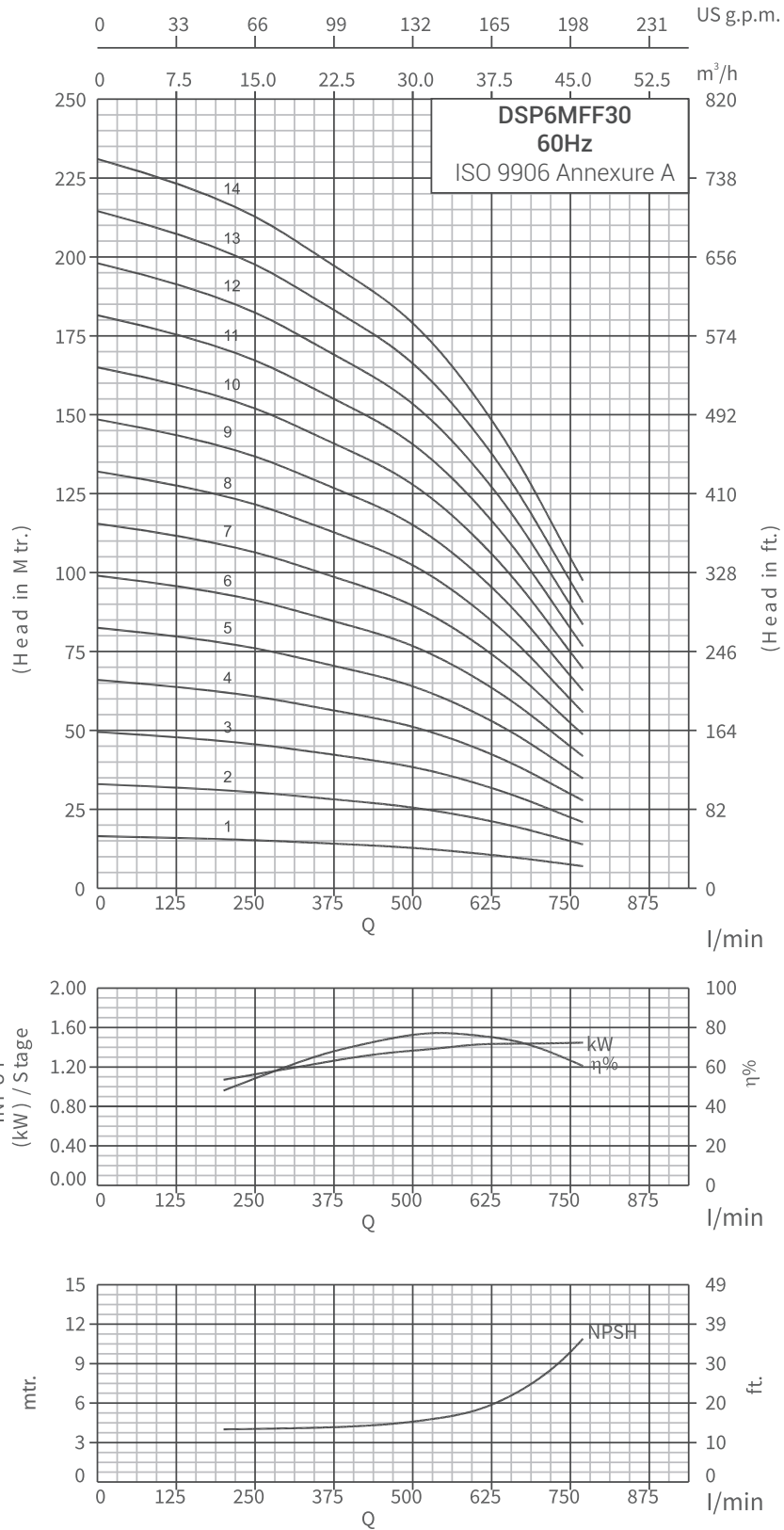

# DSP6MFF30, 60Hz

ISO 9906 Annexure A

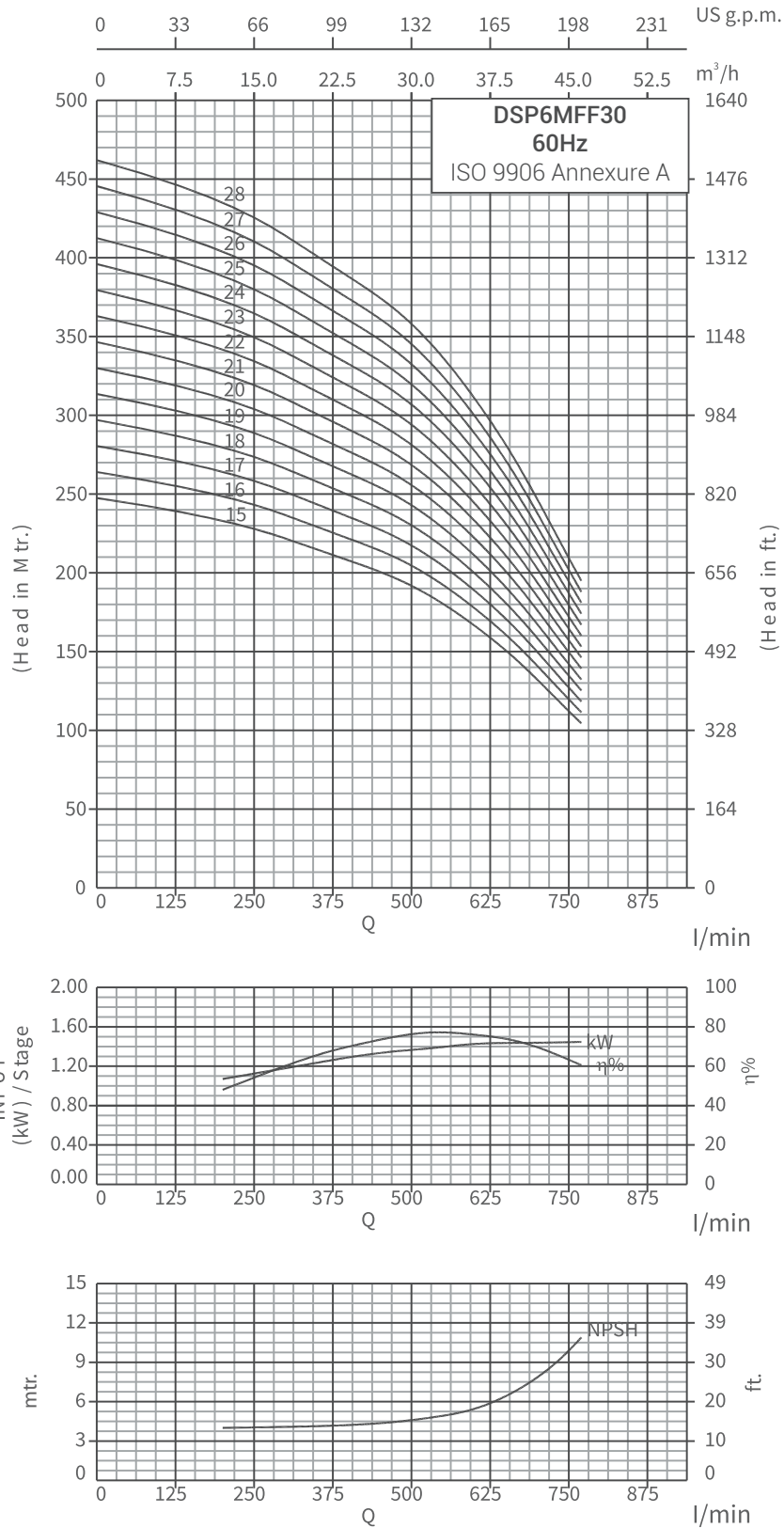

# DSP6MFF30, 60Hz

ISO 9906 Annexure A

kW	HP	Stage	Motor Joinings	Outlet Size		Discharge										
						m <sup>3</sup> /h	0	12.0	20.1	24.0	28.2	32.1	36.0	40.2	44.1	46.2
						l/min	0	200	335	400	470	535	600	670	735	770
1.5	2	1	V-6	3"BSP	Head in Mtrs.	16.5	16	14.5	14	13	12	11	10	8	7	
3	4	2	V-6	3"BSP		33	31	29	28	26	25	22	19	16	14	
4	5.5	3	V-6	3"BSP		50	47	43	42	40	37	33	29	24	21	
5.5	7.5	4	V-6	3"BSP		66	63	58	55	53	49	45	39	31	28	
7.5	10	5	V-6	3"BSP		82	79	72	69	66	62	56	48	39	35	
9.3	12.5	6	V-6	3"BSP		99	94	87	83	79	74	67	58	47	42	
9.3	12.5	7	V-6	3"BSP		116	110	101	97	92	86	78	67	55	49	
11	15	8	V-6	3"BSP		132	126	116	111	106	99	89	77	63	56	
13	17.5	9	V-6	3"BSP		148	141	130	125	119	111	100	87	71	63	
13	17.5	10	V-6	3"BSP		165	157	145	139	132	123	111	96	79	70	
15	20	11	V-6	3"BSP		182	173	159	152	145	136	123	106	86	77	
18.5	25	12	V-6	3"BSP		198	189	174	166	159	148	134	116	94	84	
18.5	25	13	V-6	3"BSP		214	204	188	180	172	160	145	125	102	90	
18.5	25	14	V-6	3"BSP		231	220	202	194	185	172	156	135	110	97	
22	30	15	V-6	3"BSP		248	236	217	208	198	185	167	145	118	104	
22	30	16	V-6	3"BSP		264	251	231	222	211	197	178	154	126	111	
22	30	17	V-6	3"BSP		280	267	246	236	225	209	189	164	134	118	
26	35	18	V-6	3"BSP		297	283	260	249	238	222	201	174	141	125	
26	35	19	V-6	3"BSP		314	298	275	263	251	234	212	183	149	132	
26	35	20	V-6	3"BSP		330	314	289	277	264	246	223	193	157	139	
30	40	21	V-6	3"BSP		346	330	304	291	277	259	234	202	165	146	
30	40	22	V-6	3"BSP		363	346	318	305	291	271	245	212	173	153	
30	40	23	V-6	3"BSP		380	361	333	319	304	283	256	222	181	160	
37	50	24	V-6	3"BSP		396	377	347	333	317	296	267	231	189	167	
37	50	25	V-6	3"BSP		412	393	362	346	330	308	278	241	196	174	
37	50	26	V-6	3"BSP		429	408	376	360	343	320	290	251	204	181	
37	50	27	V-6	3"BSP		446	424	390	374	357	333	301	260	212	188	
37	50	28	V-6	3"BSP		462	440	405	388	370	345	312	270	220	195	

# DSP6MFF30, 60Hz

ISO 9906 Annexure A

## Dimensions & Weights

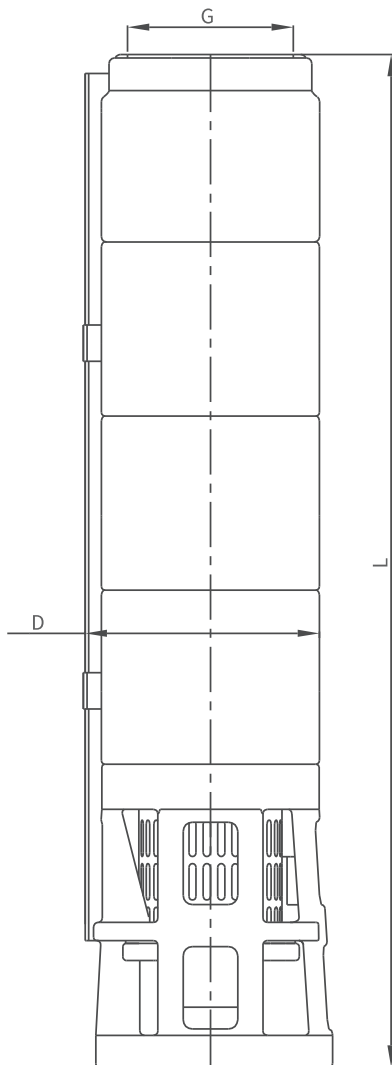

Model Name	Specification			
	D (mm)	L (mm)	Pump Weight Kg.	Weight (incl. pkg.) Kg.
DSP6MFF30-01	144	367	9	14
DSP6MFF30-02	144	463	11	16
DSP6MFF30-03	144	559	13	18
DSP6MFF30-04	144	655	15	20
DSP6MFF30-05	144	751	11	16
DSP6MFF30-06	144	847	19	24
DSP6MFF30-07	144	943	21	26
DSP6MFF30-08	144	1039	23	28
DSP6MFF30-09	144	1135	25	30
DSP6MFF30-10	144	1231	27	32
DSP6MFF30-11	144	1327	29	34
DSP6MFF30-12	144	1423	31	36
DSP6MFF30-13	144	1519	33	38
DSP6MFF30-14	144	1615	35	40
DSP6MFF30-15	144	1711	37	47
DSP6MFF30-16	144	1807	39	49
DSP6MFF30-17	144	1903	41	51
DSP6MFF30-18	144	1999	43	53
DSP6MFF30-19	144	2095	45	55
DSP6MFF30-20	144	2191	47	57
DSP6MFF30-21	144	2287	49	59
DSP6MFF30-22	144	2383	51	63
DSP6MFF30-23	144	2479	53	65
DSP6MFF30-24	144	2575	55	67
DSP6MFF30-25	144	2671	57	69
DSP6MFF30-26	144	2767	59	71
DSP6MFF30-27	144	2863	61	73
DSP6MFF30-28	144	2959	63	75

G: Available Outlet Size NPT 2.5" 13.0"

D: With Cable Guard

DP32-01 to DP32-5 pumps are also available in 4" joining.  
 DP32 -29, DP32 -31, DP32 -33, DP32 -36 & DP32 -39  
 pumps are available with mounted sleeve in 8" joining.

# 6"

## DSP6MFF46 & DSP6MFF60 SERIES PUMP DESIGN

### Material specification

No.	PART NAME	MATERIAL
1	N.R.V. 4.0"	S.S AISI 304
2	VALVE	S.S AISI 304
3	TOP & FIRST BEARING BUSH	N.B.R. + S.S AISI 304
4	INTERMEDIATE CHAMBER TOP	S.S AISI 304
5	COLLET NUT	S.S AISI 304
6	IMPELLER	S.S AISI 304
7	COLLET	S.S AISI 304
8	BEARING BUSH	NBR
9	INTERMEDIATE CHAMBER STAGE	S.S AISI 304
10	NECKRING	N.B.R. + NYLON
11	INTERMEDIATE CHAMBER 1st	S.S AISI 304
12	SPACING WASHER	25% CFT
13	FIRST STAGE NUT	S.S AISI 304
14	PUMP SHAFT	S.S. AISI 431
15	CONNECTOR	S.S AISI 304
16	CLAMPING STRIP	S.S AISI 304
17	STRAINER	S.S AISI 304
18	NEMA COUPLING	S.S AISI 304
19	CABLE GUARD	S.S AISI 304
20	SUCTION	S.S AISI 304

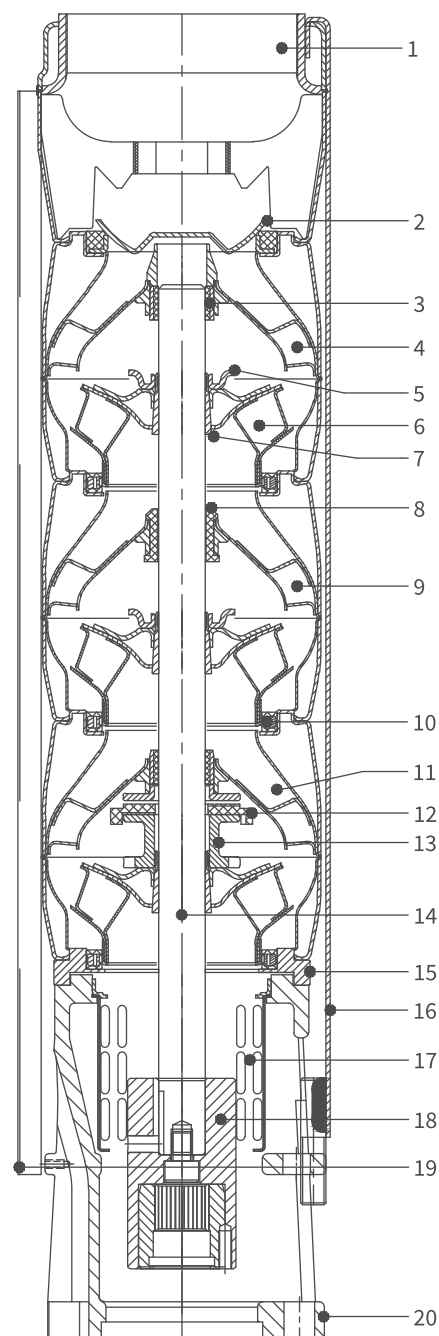

# DSP6MFF46, 60Hz

ISO 9906 Annexure A

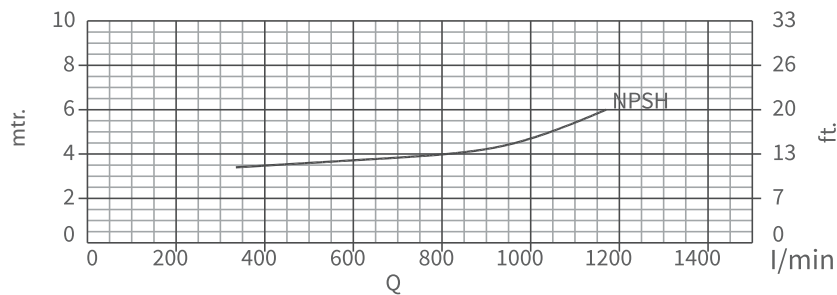
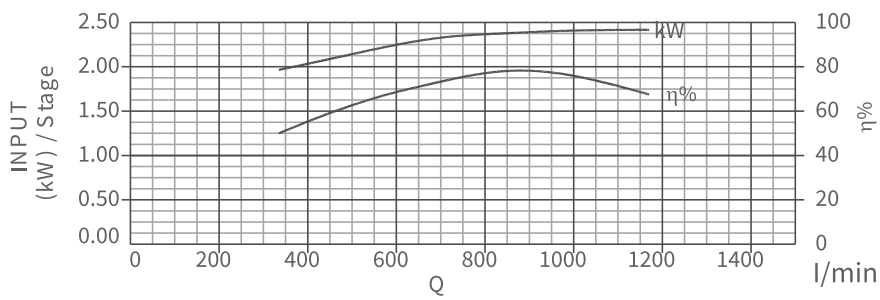
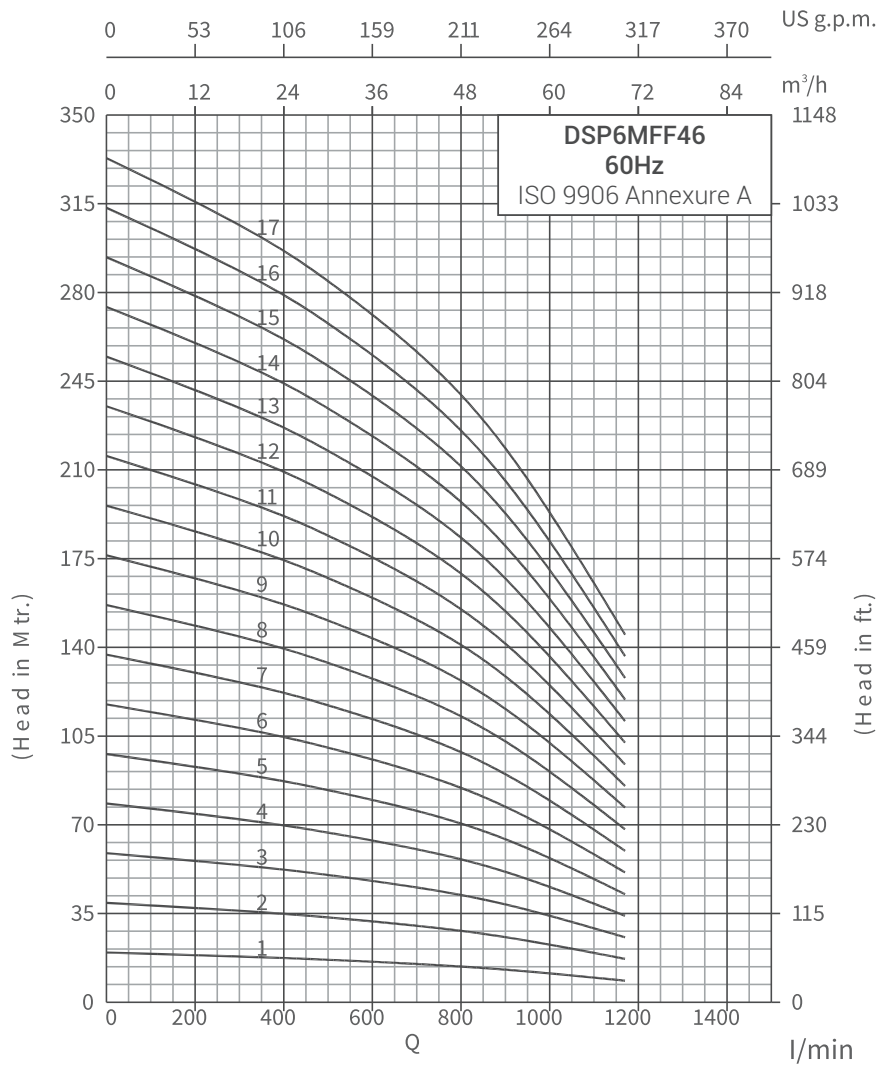

# DSP6MFF46, 60Hz

ISO 9906 Annexure A

kW	HP	Stage	Motor Joinings	Outlet Size	Discharge							
					m <sup>3</sup> /h	0	20.1	30.0	40.2	50.1	60.0	70.2
					l/min	0	335	500	670	835	1000	1170
3	4	1	V-6	3"BSP	Head in Mtrs.	20	18	17	15	14	11	9
5.5	7.5	2	V-6	3"BSP		39	36	34	31	28	23	17
7.5	10	3	V-6	3"BSP		59	54	50	46	41	34	26
9.3	12.5	4	V-6	3"BSP		78	72	67	62	55	46	34
13	17.5	5	V-6	3"BSP		98	90	84	77	69	57	43
15	20	6	V-6	3"BSP		118	108	101	92	83	69	51
18.5	25	7	V-6	3"BSP		137	126	117	108	97	80	60
18.5	25	8	V-6	3"BSP		157	144	134	123	111	92	68
22	30	9	V-6	3"BSP		176	161	151	139	124	103	77
22	30	10	V-6	3"BSP		196	179	168	154	138	115	85
26	35	11	V-6	3"BSP		215	197	184	170	152	126	94
30	40	12	V-6	3"BSP		235	215	201	185	166	138	102
30	40	13	V-6	3"BSP		255	233	218	200	180	149	111
37	50	14	V-6	3"BSP		274	251	235	216	193	161	119
37	50	15	V-6	3"BSP		294	269	251	231	207	172	128
37	50	16	V-6	3"BSP		313	287	268	247	221	184	136
37	50	17	V-6	3"BSP		333	305	285	262	235	195	145

# DSP6MFF46, 60Hz

ISO 9906 Annexure A

## Dimensions & Weights

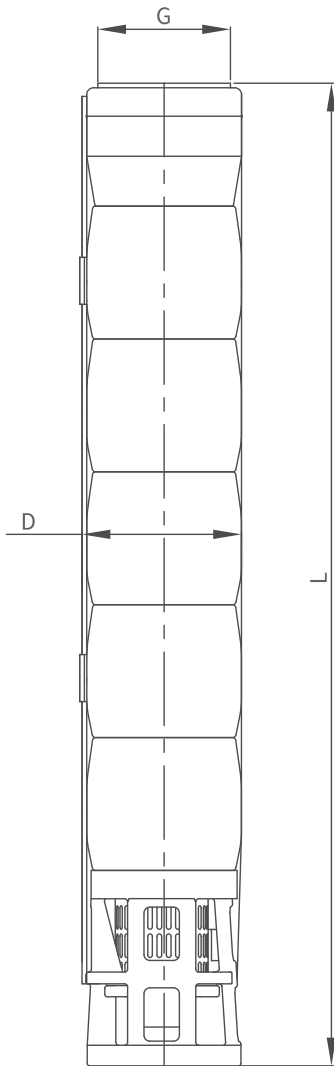

Model Name	Specification			
	D (mm)	L (mm)	Pump Weight Kg.	Weight (incl. pkg.) Kg.
DSP6MFF46 -01	147	400	10	13
DSP6MFF46 -02	147	513	12	15
DSP6MFF46 -03	147	626	14	17
DSP6MFF46 -04	147	739	16	19
DSP6MFF46 -05	147	852	18	22
DSP6MFF46 -06	147	965	20	24
DSP6MFF46 -07	147	1078	22	26
DSP6MFF46 -08	147	1191	24	28
DSP6MFF46 -09	147	1304	26	30
DSP6MFF46 -10	147	1417	28	33
DSP6MFF46 -11	147	1530	30	35
DSP6MFF46 -12	147	1643	32	39
DSP6MFF46 -13	147	1756	34	41
DSP6MFF46 -14	147	1869	36	43
DSP6MFF46 -15	147	1982	38	45
DSP6MFF46 -16	147	2095	40	48
DSP6MFF46 -17	147	2208	42	50

G: Available outlet size NPT 3" & 4"

D: With cable Guard

DP46-01 to DP46-03 pumps are also available in 4" joining.

DP46-18 & DP46-19 pumps are available in 8" joining.

DP46-20, DP46-22, & DP46-24 pumps are available with mounted sleeve in 8" joining.



# DSP6MFF60, 60Hz

ISO 9906 Annexure A

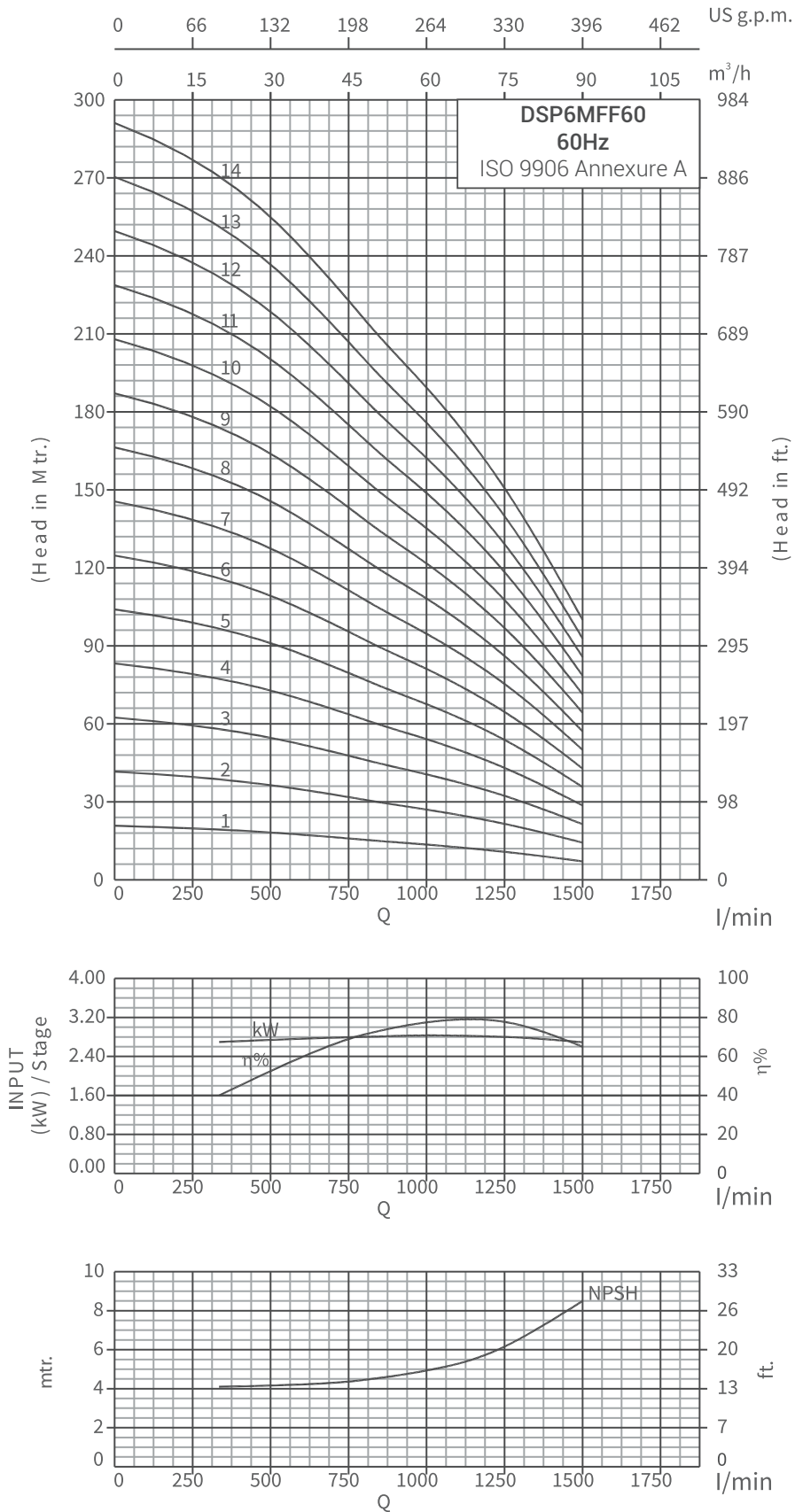

# DSP6MFF60, 60Hz

ISO 9906 Annexure A

kW	HP	Stage	Motor Joinings	Outlet Size	Discharge								
					m <sup>3</sup> /h	0	20.1	40.2	50.1	60.0	70.2	80.1	90.0
					l/min	0	335	670	835	1000	1170	1335	1500
4	5.5	1	V-6	4"BSP	Head in Mtrs.	21	20	17	15	14	12	10	7
5.5	7.5	2	V-6	4"BSP		42	39	34	30	27	24	19	14
9.3	12.5	3	V-6	4"BSP		62	59	50	45	41	35	29	21
11	15	4	V-6	4"BSP		83	79	67	60	54	47	39	29
13	17.5	5	V-6	4"BSP		104	99	84	75	68	59	49	36
18.5	25	6	V-6	4"BSP		125	118	101	90	81	71	58	43
18.5	25	7	V-6	4"BSP		146	138	118	105	95	83	68	50
22	30	8	V-6	4"BSP		166	158	134	120	109	94	78	57
26	35	9	V-6	4"BSP		187	177	151	135	122	106	87	64
26	35	10	V-6	4"BSP		208	197	168	150	136	118	97	71
30	40	11	V-6	4"BSP		229	217	185	165	149	130	107	79
37	50	12	V-6	4"BSP		249	237	201	180	163	141	117	86
37	50	13	V-6	4"BSP		270	256	218	195	176	153	126	93
37	50	14	V-6	4"BSP		291	276	235	210	190	165	136	100

# DSP6MFF60, 60Hz

ISO 9906 Annexure A

## Dimensions & Weights

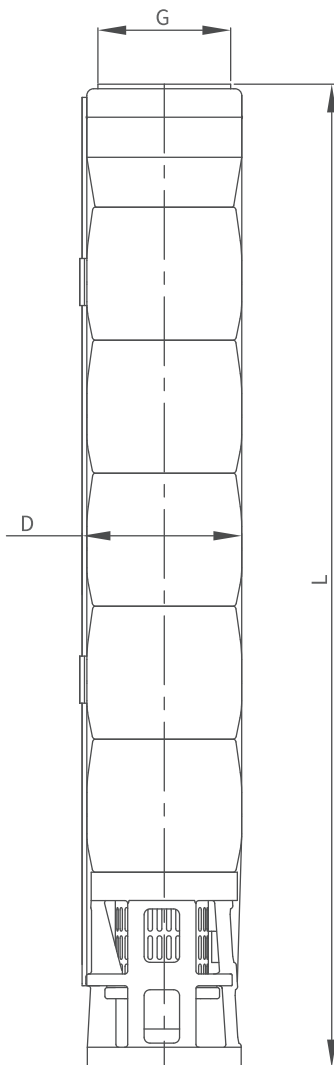

Model Name	Specification			
	D (mm)	L (mm)	Pump Weight Kg.	Weight (incl. pkg.) Kg.
DSP6MFF60-01	147	400	10	13
DSP6MFF60-02	147	513	12	15
DSP6MFF60-03	147	626	14	17
DSP6MFF60-04	147	739	16	19
DSP6MFF60-05	147	852	18	22
DSP6MFF60-06	147	965	20	24
DSP6MFF60-07	147	1078	22	26
DSP6MFF60-08	147	1191	24	28
DSP6MFF60-09	147	1304	26	30
DSP6MFF60-10	147	1417	28	33
DSP6MFF60-11	147	1530	30	35
DSP6MFF60-12	147	1643	32	39
DSP6MFF60-13	147	1756	34	41
DSP6MFF60-14	147	1869	36	43

G : Available outlet size NPT 3" & 4"

D: With cable Guard

DP60-01 to DP60-3 pumps are also available in 4" joining.

DP60 -15 to DP60 -18 pumps are available in 8" joining.

DP60 -19 to DP60 -21 pumps are available with mounted sleeve in 8" joining.

**8"**

## DSP8MFF77 & DSP8MFF95 SERIES PUMP DESIGN

### Material specification

No.	PART NAME	MATERIAL
1	DCH SLEEVE	S.S AISI 304
2	CLAMPING STRIP	S.S AISI 304
3	SPRING	S.S AISI 304
4	VALVE GUIDE RIB ASSEMBLY	S.S AISI 304
5	VALVE ASSEMBLY	S.S AISI 304
6	VALVE SEAT HOUSING	S.S AISI 304
7	FIRST STAGE BEARING BUSH	S.S AISI + NBR
8	STOP RING	S.S AISI 304
9	SPACING WASHER	25% CFT
10	FIRST STAGE NUT	S.S AISI 304
11	IMPELLER COLLET	S.S AISI 304
12	BEARING BUSH STAGE	NBR
13	COLLET NUT	S.S AISI 304
14	NECKRING	NBR + NYLON
15	IMC SLEEVE	S.S AISI 304
16	INTERMEDIATE CHAMBER	S.S AISI 304
17	IMPELLER ASSEMBLY	S.S AISI 304
18	CABLE GUARD	S.S AISI 304
19	SHAFT	S.S AISI 431
20	STRAINER	S.S AISI 304
21	NEMA COUPLING	S.S AISI 304
22	SUCTION INTERCONNECTOR	S.S AISI 304

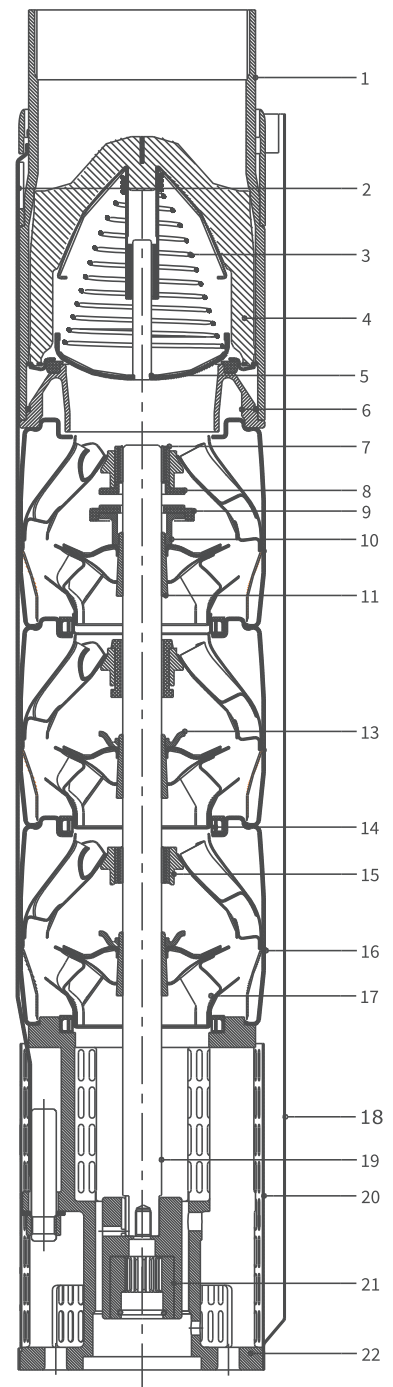

# DSP8MFF77, 60Hz

ISO 9906 Annexure A

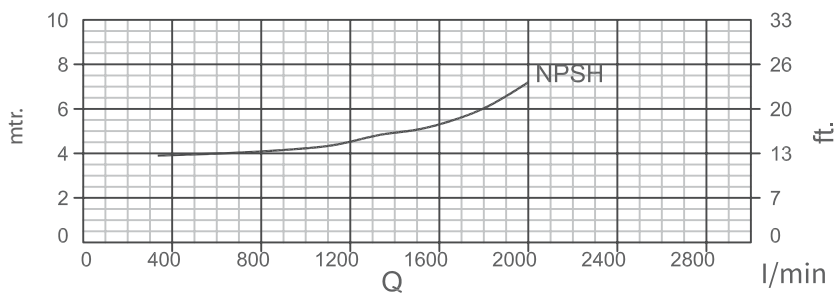
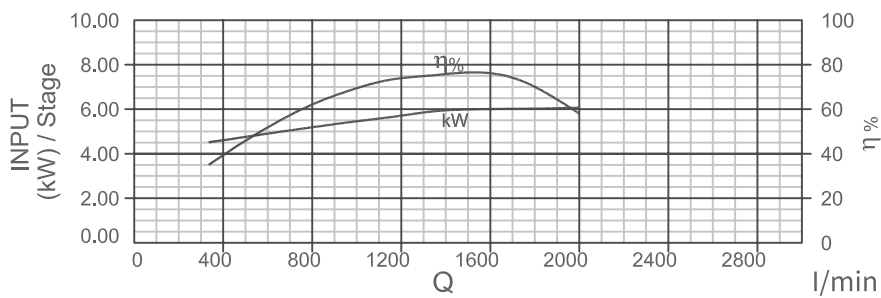
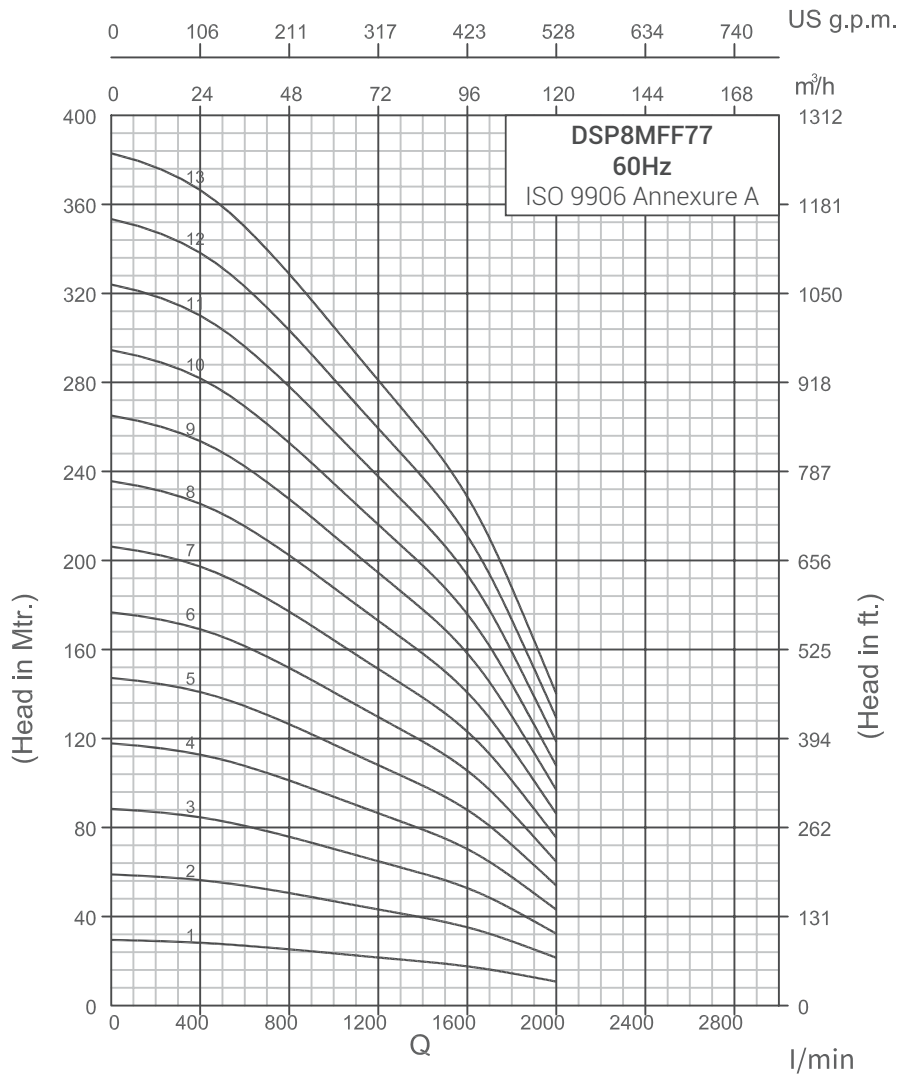

## DSP8MFF77, 60Hz

ISO 9906 Annexure A

kW	HP	Stage	Motor Joinings	Outlet Size	Discharge										
					m <sup>3</sup> /h	0	20.1	40.2	60.0	70.0	80.1	90.0	100.2	110.1	120.0
					l/min	0	335	670	1000	1166	1335	1500	1670	1835	2000
5.5	7.5	1	V-6	5"BSP	Head in Mtrs.	29.5	29	27	23	22	20	19	17	14	11
11	15	2	V-6	5"BSP		59	58	53	47	44	41	38	34	28	22
18.5	25	3	V-6	5"BSP		88	87	80	70	66	61	57	50	42	32
22	30	4	V-6	5"BSP		118	115	106	94	88	82	75	67	55	43
26	35	5	V-6	5"BSP		147	144	133	117	110	102	94	84	69	54
37	50	6	V-6	5"BSP		177	173	159	141	132	122	113	101	83	65
37	50	7	V-6	5"BSP		206	202	186	164	153	143	132	117	97	75
45	60	8	V-8	5"BSP		236	231	212	188	175	163	151	134	111	86
55	75	9	V-8	5"BSP		265	260	239	211	197	183	170	151	125	97
55	75	10	V-8	5"BSP		294	288	265	235	219	204	188	168	138	108
63	85	11	V-8	5"BSP		324	317	292	258	241	224	207	184	152	118
63	85	12	V-8	5"BSP		353	346	318	282	263	245	226	201	166	129
75	100	13	V-8	5"BSP		383	375	345	305	285	265	245	218	180	140

## Dimensions & Weights

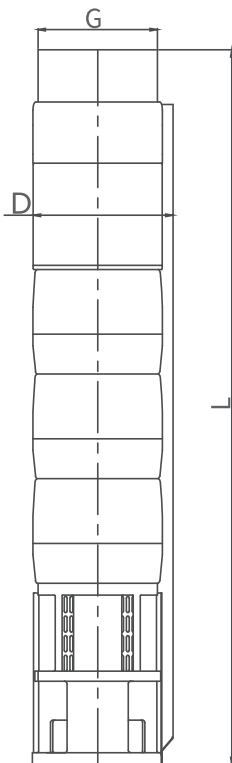

Model Name	Specification			
	D (mm)	L (mm)	Pump Weight (in Kg.)	Pump Weight (incl. pkg.)kg
DSP8MFF77 -01	188	620	21	24
DSP8MFF77 -02	188	748	25	28
DSP8MFF77 -03	188	876	29	31
DSP8MFF77 -04	188	1004	33	36
DSP8MFF77 -05	188	1132	37	40
DSP8MFF77 -06	188	1260	41	44
DSP8MFF77 -07	188	1388	45	48
DSP8MFF77 -08	196	1516	49	52
DSP8MFF77 -09	196	1644	53	56
DSP8MFF77 -10	196	1772	55	58
DSP8MFF77 -11	196	1900	59	62
DSP8MFF77 -12	196	2028	63	66
DSP8MFF77 -13	196	2156	67	70

G: Available Outlet Size NPT 5"

D: Maximum Diameter With Single Cable Guard

D: Maximum Diameter With Double Cable Guard upto 50 HP 6" Motor Joining

DP77-01 to DP77-07 pump are available in 6" joining

DP77-08 to DP77-13 pump are available in 8" joining

# DSP8MFF95, 60Hz

ISO 9906 Annexure A

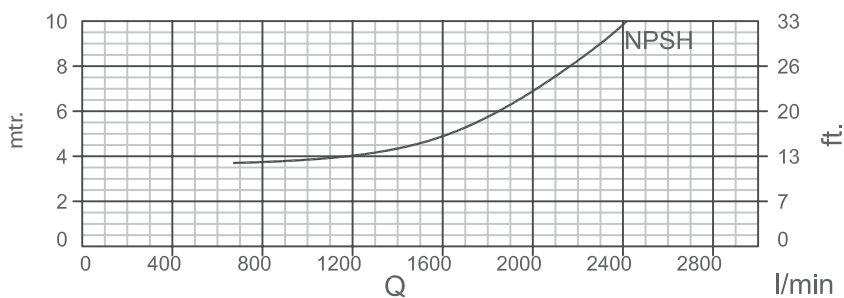
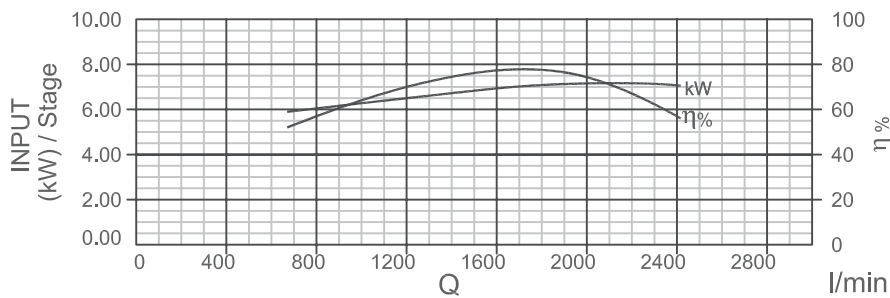
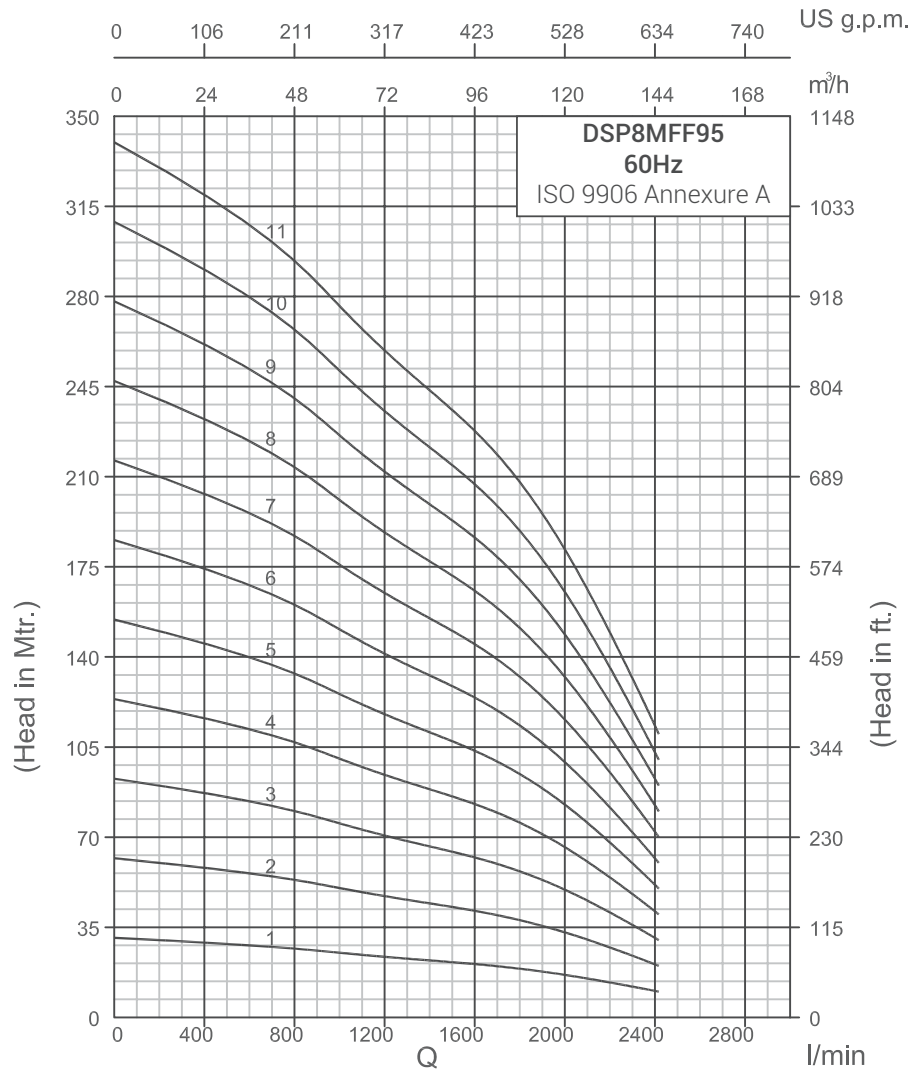

## DSP8MFF95, 60Hz

ISO 9906 Annexure A

kW	HP	Stage	Motor Joinings	Outlet Size	Discharge								
					m <sup>3</sup> /h	0	40.2	60.0	80.1	100.2	120.0	140.1	145.0
					l/min	0	670	1000	1335	1670	2000	2335	2417
7.5	10	1	V-6	5"BSP	Head in Mtrs.	31	28	25	23	20	17	11	10
13	17.5	2	V-6	5"BSP		62	56	50	45	41	34	23	20
22	30	3	V-6	5"BSP		93	84	75	68	61	50	34	30
26	35	4	V-6	5"BSP		124	112	100	90	81	67	46	40
37	50	5	V-6	5"BSP		154	140	125	113	102	84	57	50
37	50	6	V-6	5"BSP		185	168	150	135	122	101	69	60
45	60	7	V-8	5"BSP		216	196	175	158	143	118	80	70
55	75	8	V-8	5"BSP		247	224	200	180	163	135	92	80
63	85	9	V-8	5"BSP		278	252	225	203	183	151	103	90
63	85	10	V-8	5"BSP		309	280	250	225	204	168	114	100
75	100	11	V-8	5"BSP		340	308	275	248	224	185	126	110

## Dimensions & Weights

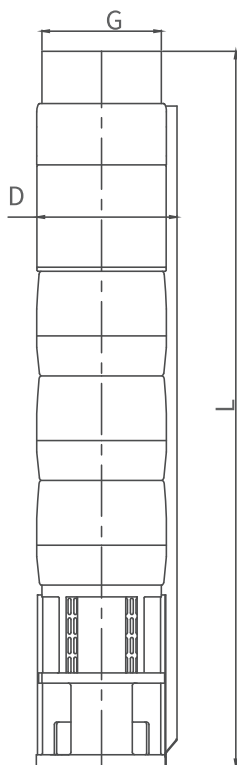

Model Name	Specification			
	D (mm)	L (mm)	Pump Weight (in Kg.)	Pump Weight (incl. pkg.)kg
DSP8MFF95 - 01	188	620	21	24
DSP8MFF95 - 02	188	748	25	28
DSP8MFF95 - 03	188	876	29	32
DSP8MFF95 - 04	188	1004	33	36
DSP8MFF95 - 05	188	1132	37	40
DSP8MFF95 - 06	188	1260	41	44
DSP8MFF95 - 07	196	1388	45	48
DSP8MFF95 - 08	196	1516	49	52
DSP8MFF95 - 09	196	1644	53	56
DSP8MFF95 - 10	196	1772	55	58
DSP8MFF95 - 11	196	1900	59	61

G: Available Outlet Size NPT 5"

D: Maximum Diameter With Single Cable Guard

D: Maximum Diameter With Double Cable Guard upto 50 HP 6" Motor Joining

DP95 -01 to DP95 -06 pump are available in 6" joining

DP95 -07 to DP95 -11 pump are available in 8" joining



10"

## DSP10MFF125 SERIES PUMP DESIGN

### Material specification

No.	PART NAME	MATERIAL
1	DCH SLEEVE	S.S AISI 304
2	CLAMPING STRIP	S.S AISI 304
3	SPRING	S.S AISI 304
4	VALVE GUIDE RIB ASSEMBLY	S.S AISI 304
5	VALVE ASSEMBLY	S.S AISI 304
6	VALVE SEAT HOUSING	S.S AISI 304
7	FIRST STAGE BEARING BUSH	S.S AISI + NBR
8	STOP RING	S.S AISI 304
9	SPACING WASHER	25% CFT
10	FIRST STAGE NUT	S.S AISI 304
11	IMPELLER COLLET	S.S AISI 304
12	BEARING BUSH STAGE	NBR
13	COLLET NUT	S.S AISI 304
14	NECKRING	NBR + NYLON
15	IMC SLEEVE	S.S AISI 304
16	INTERMEDIATE CHAMBER	S.S AISI 304
17	IMPELLER ASSEMBLY	S.S AISI 304
18	CABLE GUARD	S.S AISI 304
19	SHAFT	S.S AISI 431
20	STRAINER	S.S AISI 304
21	NEMA COUPLING	S.S AISI 304
22	SUCTION INTERCONNECTOR	S.S AISI 304

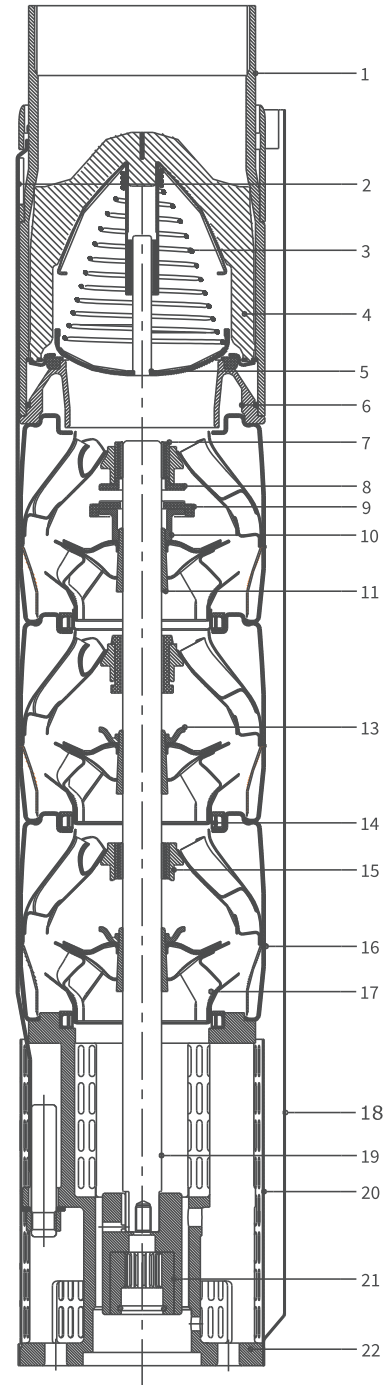

# DSP10MFF125, 60Hz

ISO 9906 Annexure A

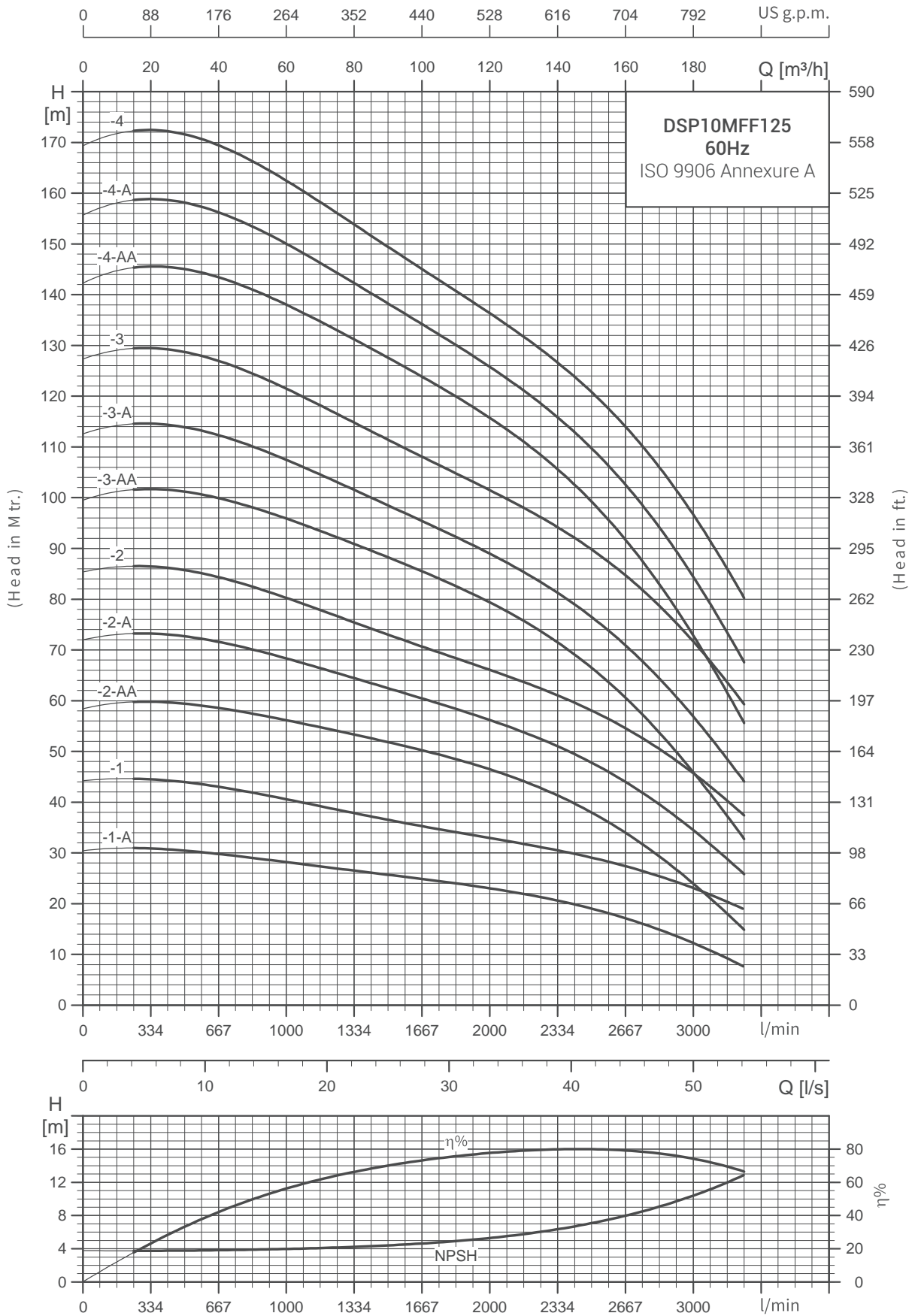

# DSP10MFF125, 60Hz

ISO 9906 Annexure A

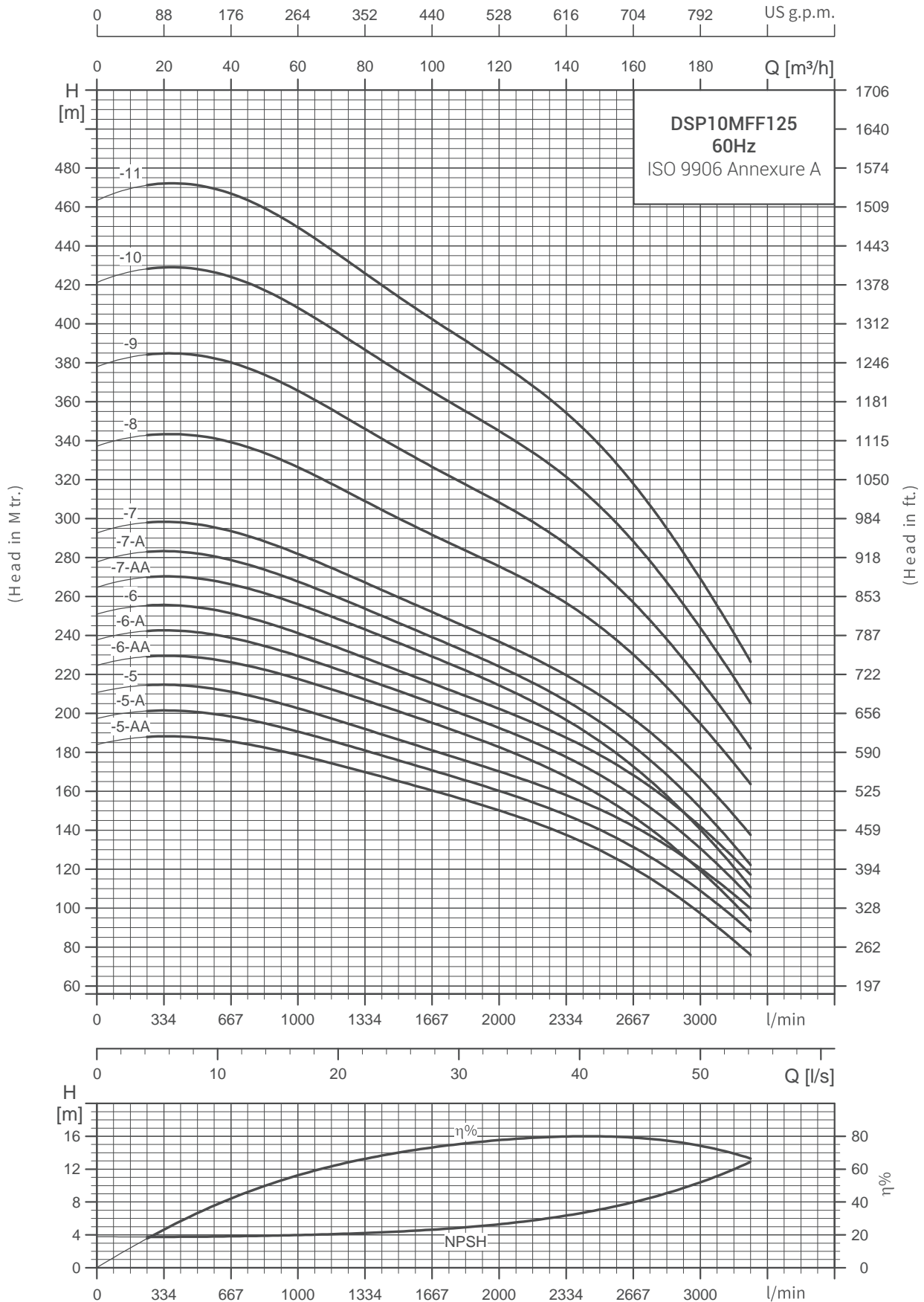

# DSP10MFF125, 60Hz

ISO 9906 Annexure A

kW	HP	Stage	Motor Joinings	Outlet Size	Head in Mtrs.	Discharge								
						m <sup>3</sup> /h	0	35	65	95	125	155	185	190
						l/min	0	583	1083	1583	2083	2582	3082	3165
11	15	1-A	V-6	6"BSP	30	29	28	26	22	18	8	8		
18.5	25	1	V-6	6"BSP	44	42	40	36	32	28	22	18		
22	30	2-AA	V-6	6"BSP	58	56	55	54	52	46	26	16		
26	35	2-A	V-6	6"BSP	72	70	68	62	54	46	26	26		
30	40	2	V-6	6"BSP	86	84	78	72	64	56	38	38		
37	50	3-AA	V-6	6"BSP	100	97	94	86	78	62	32	33		
37	50	3-A	V-6	6"BSP	113	111	108	100	92	76	46	44		
45	60	3	V-8	6"BSP	127	125	120	110	100	88	67	60		
55	75	4-AA	V-8	6"BSP	142	144	136	126	114	96	67	58		
55	75	4-A	V-8	6"BSP	156	158	148	145	124	116	79	68		
63	85	4	V-8	6"BSP	169	171	160	147	134	118	91	80		
75	100	5-AA	V-8	6"BSP	184	186	176	163	147	125	90	76		
75	100	5-A	V-8	6"BSP	197	200	190	175	156	136	104	90		
75	100	5	V-8	6"BSP	210	212	200	185	167	146	115	100		
75	100	6-AA	V-8	6"BSP	225	227	215	185	180	154	116	95		
93	125	6-A	V-8	6"BSP	237	240	226	210	190	162	122	105		
93	125	6	V-8	6"BSP	250	257	240	220	200	175	135	117		
93	125	7-AA	V-8	6"BSP	265	267	255	236	210	180	130	110		
93	125	7-A	V-8	6"BSP	277	280	265	244	220	190	142	122		
110	150	7	V-8	6"BSP	292	295	280	255	235	204	156	140		
130	175	8	V-10	6"BSP	337	340	321	295	270	239	185	165		
130	175	9	V-10	6"BSP	377	381	360	330	270	265	205	182		
150	200	10	V-10	6"BSP	420	425	401	370	340	296	230	205		
185	250	11	V-10	6"BSP	463	470	445	410	375	300	255	225		

# DSP10MFF125, 60Hz

ISO 9906 Annexure A

## Dimensions and weights

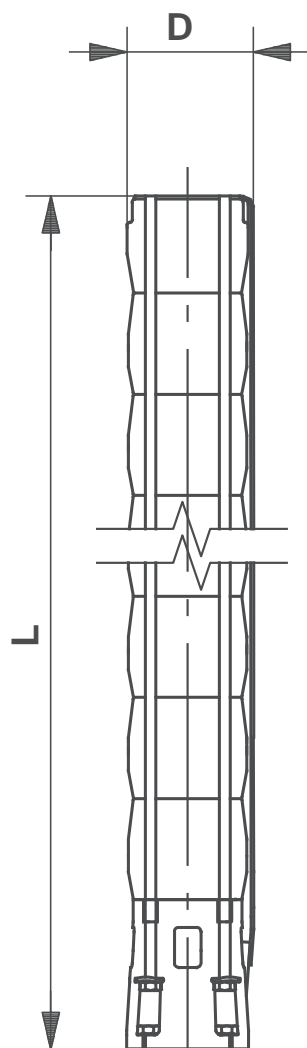

Model Name	Specification			
	D (mm)	L (mm)	Pump Weight (in Kg.)	Pump Weight (incl. pkg.)kg
DSP10MFF125 - 1-A	211	652	81	84
DSP10MFF125 - 1	211	652	93	96
DSP10MFF125 - 2-AA	211	807	105	108
DSP10MFF125 - 2-A	211	807	111	114
DSP10MFF125 - 2	211	807	119	122
DSP10MFF125 - 3-AA	211	850	167	170
DSP10MFF125 - 3-A	211	850	167	170
DSP10MFF125 - 3	213	963	226	229
DSP10MFF125 - 4-AA	213	1118	247	250
DSP10MFF125 - 4-A	213	1118	247	250
DSP10MFF125 - 4	213	1118	273	276
DSP10MFF125 - 5-AA	213	1274	296	299
DSP10MFF125 - 5-A	213	1274	296	299
DSP10MFF125 - 5	213	1274	296	299
DSP10MFF125 - 6-AA	213	1429	302	305
DSP10MFF125 - 6-A	213	1429	348	351
DSP10MFF125 - 6	213	1429	348	351
DSP10MFF125 - 7-AA	213	1585	354	357
DSP10MFF125 - 7-A	213	1585	354	357
DSP10MFF125 - 7	213	1585	404	407
DSP10MFF125 - 8	237	2092	532	535
DSP10MFF125 - 9	237	2248	538	541
DSP10MFF125 - 10	237	2403	609	612
DSP10MFF125 - 11	237	2559	655	658

# DSP10MFF160, 60Hz

ISO 9906 Annexure A

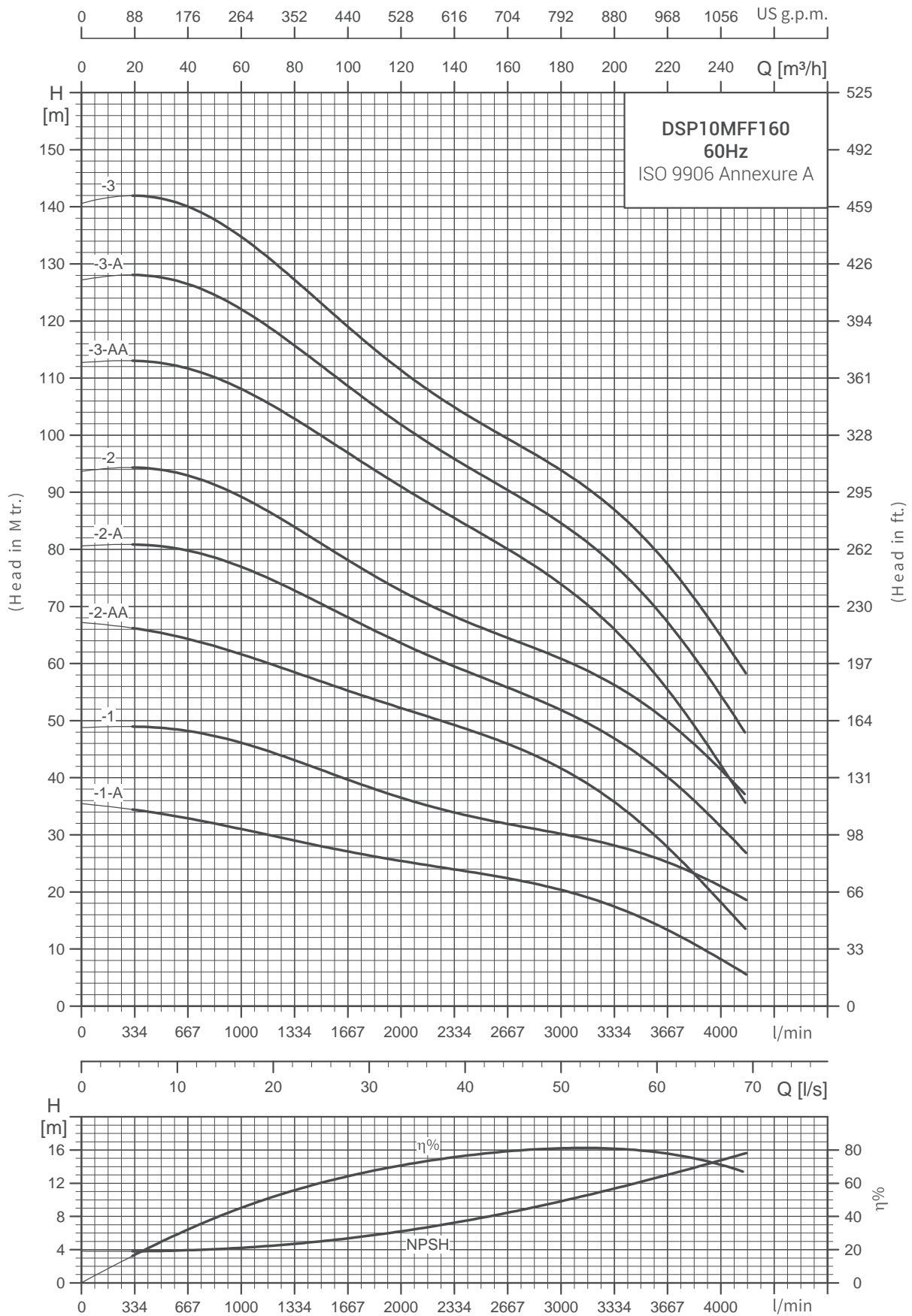

# DSP10MFF160, 60Hz

ISO 9906 Annexure A

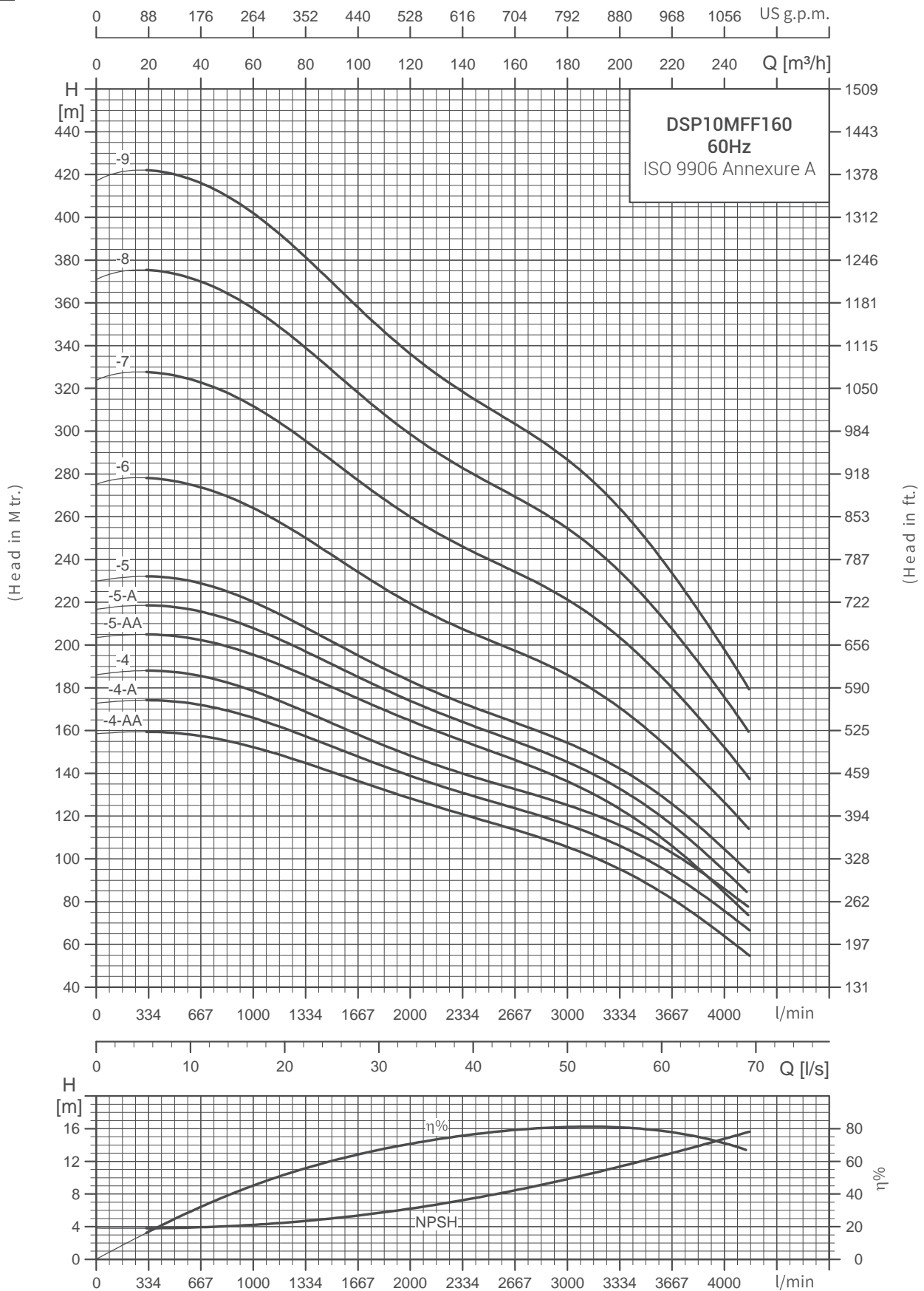

# DSP10MFF160, 60Hz

ISO 9906 Annexure A

kW	HP	Stage	Motor Joinings	Outlet Size	Discharge								
					m <sup>3</sup> /h	0	30	70	110	150	190	230	250
					l/min	0	500	1166	1833	2499	3165	3832	4165
15	20	1-A	V-6	6"BSP	Head in Mtrs.	36	34	30	26	23	29	11	6
22	30	1	V-6	6"BSP		49	48	44	38	32	29	23	18
26	35	2-AA	V-6	6"BSP		68	65	60	54	48	38	24	14
37	50	2-A	V-6	6"BSP		81	80	74	66	58	48	36	26
37	50	2	V-6	6"BSP		94	92	88	74	66	58	46	38
45	60	3-AA	V-8	6"BSP		113	112	106	94	82	70	49	36
55	75	3-A	V-8	6"BSP		127	126	119	106	93	81	61	48
55	75	3	V-8	6"BSP		141	140	131	116	112	90	71	58
63	85	4-AA	V-8	6"BSP		160	159	150	132	116	100	72	55
75	100	4-A	V-8	6"BSP		175	173	165	142	126	110	82	65
75	100	4	V-8	6"BSP		190	186	175	154	135	120	95	76
93	125	5-AA	V-8	6"BSP		205	203	190	170	150	130	95	75
93	125	5-A	V-8	6"BSP		220	216	203	180	160	140	105	85
93	125	5	V-8	6"BSP		235	232	215	190	166	150	115	95
110	150	6	V-8	6"BSP		275	274	256	225	200	180	140	115
130	175	7	V-10	6"BSP		325	323	305	268	240	215	165	136
150	200	8	V-10	6"BSP		370	368	350	305	275	245	190	160
185	250	9	V-10	6"BSP		420	418	390	345	310	275	215	180

## Dimensions and weights

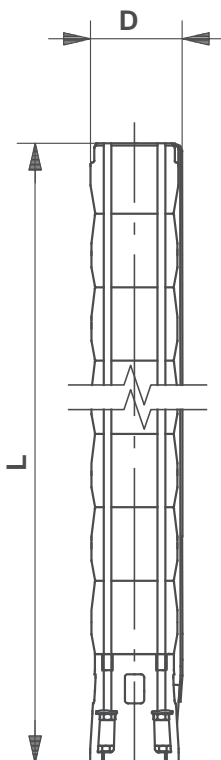

Model Name	Specification			
	D (mm)	L (mm)	Pump Weight (in Kg.)	Pump Weight (incl. pkg.)kg
DSP10MFF160 - 1-A	211	652	88	91
DSP10MFF160 - 1	211	652	99	102
DSP10MFF160 - 2-AA	211	807	111	114
DSP10MFF160 - 2-A	211	694	161	164
DSP10MFF160 - 2	211	694	161	164
DSP10MFF160 - 3-AA	213	963	226	229
DSP10MFF160 - 3-A	213	963	241	244
DSP10MFF160 - 3	213	963	241	244
DSP10MFF160 - 4-AA	213	1118	271	274
DSP10MFF160 - 4-A	213	1118	290	293
DSP10MFF160 - 4	213	1118	290	293
DSP10MFF160 - 5-AA	213	1274	342	345
DSP10MFF160 - 5-A	213	1274	342	345
DSP10MFF160 - 5	213	1274	342	345
DSP10MFF160 - 6	213	1729	408	411
DSP10MFF160 - 7	237	1937	526	529
DSP10MFF160 - 8	237	2092	597	600
DSP10MFF160 - 9	237	2248	643	646



# 10"

## DSP10MFF215 SERIES PUMP DESIGN

### Material specification

No.	PART NAME	MATERIAL
1	DCH SLEEVE	S.S AISI 304
2	CLAMPING STRIP	S.S AISI 304
3	SPRING	S.S AISI 304
4	VALVE GUIDE RIB ASSEMBLY	S.S AISI 304
5	VALVE ASSEMBLY	S.S AISI 304
6	VALVE SEAT HOUSING	S.S AISI 304
7	FIRST STAGE BEARING BUSH	S.S AISI + NBR
8	STOP RING	S.S AISI 304
9	SPACING WASHER	25% CFT
10	FIRST STAGE NUT	S.S AISI 304
11	IMPELLER COLLET	S.S AISI 304
12	BEARING BUSH STAGE	NBR
13	COLLET NUT	S.S AISI 304
14	NECKRING	NBR + PPS
15	IMC SLEEVE	S.S AISI 304
16	INTERMEDIATE CHAMBER	S.S AISI 304
17	IMPELLER ASSEMBLY	S.S AISI 304
18	CABLE GUARD	S.S AISI 304
19	SHAFT	S.S AISI 431
20	STRAINER	S.S AISI 304
21	NEMA COUPLING	S.S AISI 304
22	SUCTION INTERCONNECTOR	S.S AISI 304

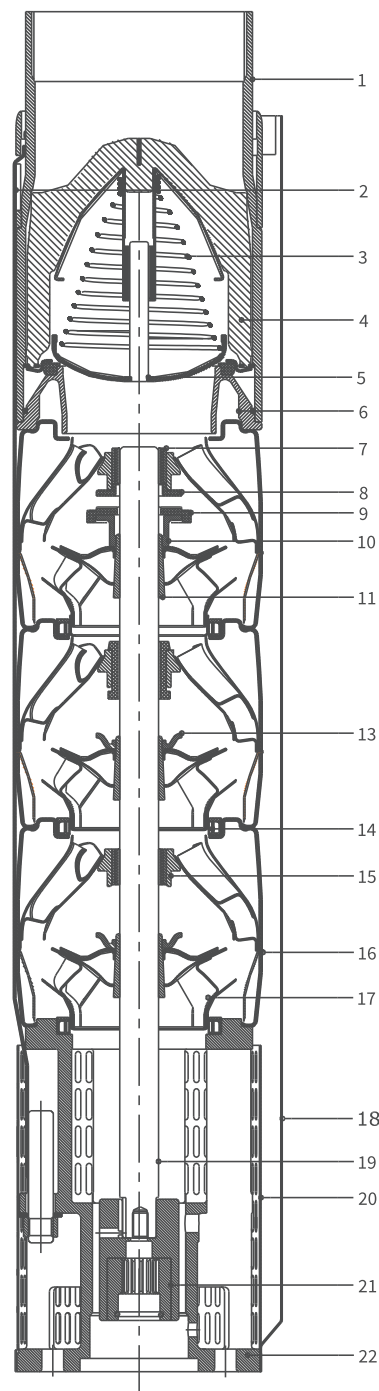

# DSP10MFF215, 60Hz

ISO 9906 Annexure A

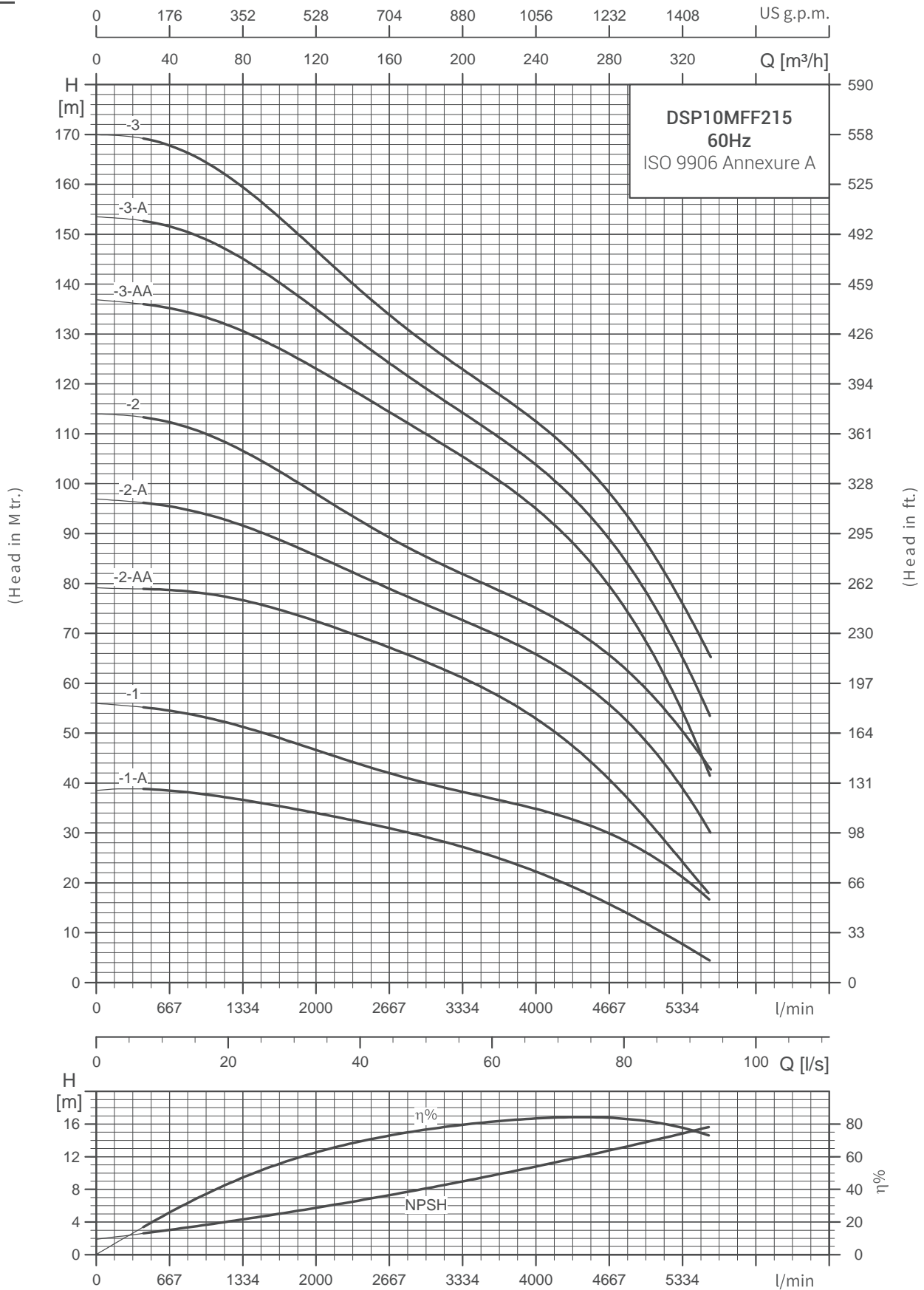

# DSP10MFF215, 60Hz

ISO 9906 Annexure A

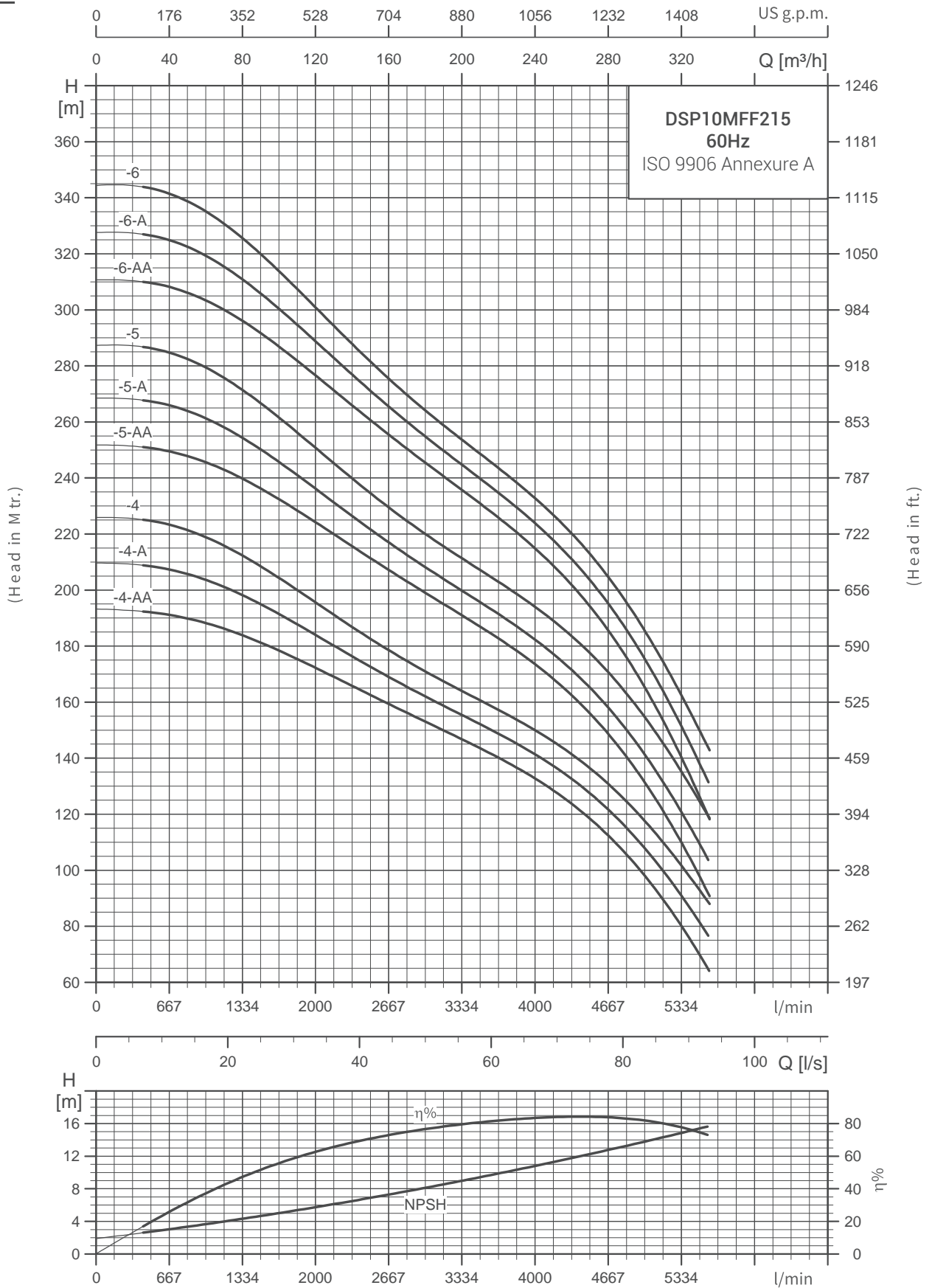

# DSP10MFF215, 60Hz

ISO 9906 Annexure A

kW	HP	Stage	Motor Joinings	Outlet Size	Discharge								
					m <sup>3</sup> /h	0	70	110	150	190	230	270	330
					l/min	0	1166	1833	2499	3165	3832	4498	5498
22	30	1-A	V-8	6"BSP	Head in Mtrs.	39	37	35	32	28	24	18	6
30	40	1	V-8	6"BSP		56	52	48	43	38	36	32	18
45	60	2-AA	V-8	6"BSP		79	77	74	68	63	56	44	20
55	75	2-A	V-8	6"BSP		97	93	87	80	74	68	59	34
63	90	2	V-8	6"BSP		114	108	100	91	84	77	69	46
75	100	3-AA	V-8	6"BSP		137	132	125	116	108	98	84	46
93	125	3-A	V-8	6"BSP		154	147	138	126	116	107	94	58
93	125	3	V-8	6"BSP		170	162	150	137	128	118	102	70
110	150	4-AA	V-8	6"BSP		194	185	175	162	150	135	120	70
110	150	4-A	V-8	6"BSP		210	200	186	172	159	145	126	83
110	150	4	V-8	6"BSP		226	216	200	183	166	155	136	93
130	175	5-AA	V-8	6"BSP		253	242	226	212	195	176	156	100
130	175	5-A	V-10	6"BSP		268	256	240	222	205	187	165	110
150	200	5	V-10	6"BSP		287	275	255	235	215	200	177	125
185	250	6-AA	V-10	6"BSP		310	300	283	260	240	220	195	126
185	250	6-A	V-10	6"BSP		327	316	295	270	250	230	203	137
185	250	6	V-10	6"BSP		345	330	307	284	259	240	214	157

## Dimensions and weights

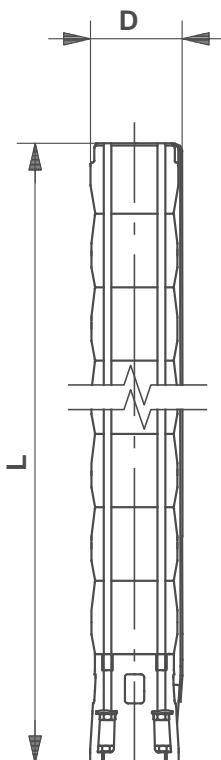

Model Name	Specification			
	D (mm)	L (mm)	Pump Weight (in Kg.)	Pump Weight (incl. pkg.)kg
DSP10MFF215 - 1-A	236	790	106	109
DSP10MFF215 - 1	236	790	120	123
DSP10MFF215 - 2-AA	239	966	231	234
DSP10MFF215 - 2-A	239	966	246	249
DSP10MFF215 - 2	239	966	272	275
DSP10MFF215 - 3-AA	239	1142	301	304
DSP10MFF215 - 3-A	239	1142	347	350
DSP10MFF215 - 3	239	1142	347	350
DSP10MFF215 - 4-AA	239	1318	407	410
DSP10MFF215 - 4-A	239	1318	407	410
DSP10MFF215 - 4	239	1318	407	410
DSP10MFF215 - 5-AA	250	1494	519	522
DSP10MFF215 - 5-A	250	1494	519	522
DSP10MFF215 - 5	250	1494	584	587
DSP10MFF215 - 6-AA	250	1670	634	637
DSP10MFF215 - 6-A	250	1670	634	637
DSP10MFF215 - 6	250	1670	634	637

## Connecting pieces

The tables below show the range of connecting pieces for connection of thread-to-flange and thread-to-thread.

### Thread-to-flange (standard flange to EN 1092-1)

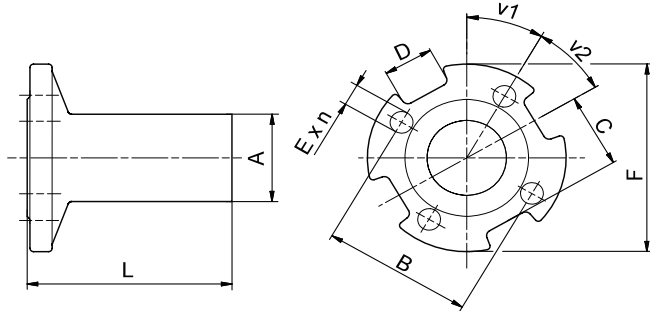

Dimensional sketch and photo of the connecting piece thread-to-tread

Type	Pump outlet	Connecting piece	A	Dimensions (mm)						V1	V2	n
				B	C	D	E	F	L			
DP 17	Rp 2½	R 2½ → DN 50 PN 16/40	R 2½	125	65	40	∅19	∅165	172	90	90	4
		R 2½ → DN 65 PN 16/40	R 2½	145	71	30	∅19	∅185	172	45	45	8
		R 2½ → DN 80 PN 16/40	R 2½	160	82.5	40	∅19	∅200	172	45	45	8
DP 30	Rp 3	R 3 → DN 65 PN 16/40	R 3	145	71	30	∅19	∅185	172	45	45	8
		R 3 → DN 80 PN 16/40	R 3	160	82.5	40	∅19	∅200	172	45	45	8
		R 3 → DN 100 PN 40	R 3	190	100	40	∅23	∅235	172	45	45	8
		R 3 → DN 100 PN 16	R 3	180	100	40	∅19	∅220	172	45	45	8
DP 46 DP 60	Rp 3 Rp 4	R 3 → DN 65 PN 16/40	R 3	145	71	30	∅19	∅185	172	45	45	8
		R 3 → DN 80 PN 16/40	R 3	160	82.5	40	∅19	∅200	172	45	45	8
		R 3 → DN 100 PN 16	R 3	180	100	40	∅19	∅220	172	45	45	8
		R 3 → DN 100 PN 40	R 3	190	100	40	∅23	∅235	172	45	45	8
DP 77 DP 95	Rp 4 Rp 5	R 4 → DN 100 PN 16	R 4	180	100	40	∅19	∅235	182	45	45	8
		R 4 → DN 100 PN 40	R 4	190	100	40	∅23	∅235	182	45	45	8
		R 5 → DN 100 PN 16	R 5	180	82	35	∅19	∅220	197	45	45	8
		R 5 → DN 100 PN 40	R 5	190	82	35	∅23	∅235	197	45	45	8
		R 5 → DN 125 PN 16	R 5	210	99	37	∅19	∅250	197	45	45	8
		R 5 → DN 125 PN 40	R 5	220	99	37	∅28	∅270	197	45	45	8
DP 125 DP 160 DP 215	Rp 5 Rp 6	R 5 → DN 150 PN 16	R 5	240	115	36	∅23	∅285	197	45	45	8
		R 5 → DN 150 PN 40	R 5	250	115	36	∅28	∅300	197	45	45	8
		R 6 → DN 125 PN 16	R 6	210	99	36	∅19	∅250	197	45	45	8
		R 6 → DN 125 PN 40	R 6	220	99	36	∅28	∅270	197	45	45	8
		R 6 → DN 150 PN 16	R 6	240	114	36	∅23	∅285	197	45	45	8
		R 6 → DN 150 PN 40	R 6	250	114	36	∅28	∅300	197	45	45	8
	Rp 6	R 6 → DN 200 PN 16	R 6	295	134	36	∅23	∅340	197	30	30	12
		R 6 → DN 200 PN 40	R 6	320	151	36	∅31	∅375	200	30	30	12

### Thread-to-flange

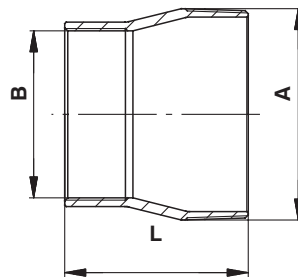

Dimensional sketch and photo of the connecting piece thread-to-tread

Type	Pump outlet	Connecting piece	Dimensions (mm)		L (mm)
			A	B	
DP 77 DP 95	Rp 5	R 5 → Rp 4	R 5	Rp 4	121
		R 5 → Rp 6	R 5	Rp 6	150
	NPT 5	NPT 5 → NPT 4	NPT 5	NPT 4	121
		NPT 5 → NPT 6	NPT 5	NPT 6	150
DP 125 DP 160 DP 215	Rp 6	Rp 6 → Rp 5	R 6	Rp 5	150
	NPT 6	NPT 6 → NPT 5	NPT 6	NPT 5	150

## Our Achievements



National Quality Award -2010 by Hon. President of India Smt. Pratibha Patil



Entrepreneurship Award-2010 by Hon. Chief Minister of Gujarat Shri Narendra Modi



Best MSME Awards 2012-13



National Quality Award - 2006



Rajasthan Energy Conservation Award - 2012



National Entrepreneurship Award - 2009



EMPOWER Award - 2009



Super SME Award - 2016



National Lean Manufacturing System Award - 2016



MSME Award - 2010



Best MSME Award 2013 - 14

## Our Awards & Certificate





Wide products range of  
**Submersible Pumpsets, uPVC Pipes & Cables**



National Quality Award & Entrepreneurship  
Award Winner Company





**Duke Plasto Technique Private Limited**

Palanpur-385510 (N. Gujarat) India

[www.dukepumps.com](http://www.dukepumps.com)